

# Raccores

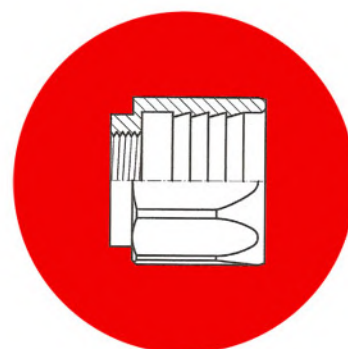

C/Riumors, 7 - 17600 Figueres  
Tel.972 50 45 25 - 972 50 04 80 Fax 972 67 11 51  
info@imafigueres.com - www.imafigueres.com

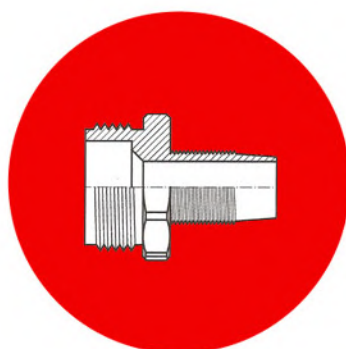
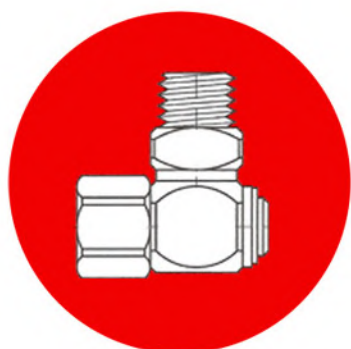

## RACORES PRENSADOS SAE 100 - R-1 R-2

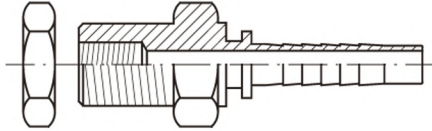

### RACOR MACHO CON TUERCA FIJACION

CODIGO	Φ TUBO	ROSCAS
100-00-03	R 2 - 3/16"	M 1/4" GAS - H 8/125
100-00-04	R 2 - 1/4"	M 1/4" GAS - H 8/125
232-601		TUERCA 1/4" GAS

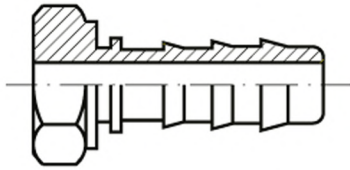

### RACOR SEMI-ACABADO BAJO (para soldar)

CODIGO	Φ TUBO
101-00-04	R 2 - 1/4"
101-00-05	R 2 - 5/16"
101-00-06	R 2 - 3/8"
101-00-08	R 2 - 1/2"
101-00-10	R 2 - 5/8"
101-00-12	R 2 - 3/4"
101-00-16	R 2 - 1"
101-00-20	R 2 - 1 1/4"
101-00-24	R 2 - 1 1/2"

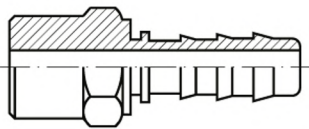

### RACOR SEMI-ACABADO ALTO (para mecaniozar)

CODIGO	Φ TUBO
102-00-04	R 2 - 1/4"
102-00-05	R 2 - 5/16"
102-00-06	R 2 - 3/8"
102-00-08	R 2 - 1/2"
102-00-10	R 2 - 5/8"
102-00-12	R 2 - 3/4"
102-00-16	R 2 - 1"
102-00-20	R 2 - 1 1/4"
102-00-24	R 2 - 1 1/2"
102-00-32	R 2 - 2"



## RACORES PRENSADOS SAE 100 - R-1 R-2

ESPIGA AMERICANA

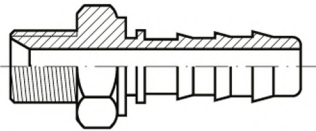

### RACOR MACHO GAS

CODIGO	Φ TUBO	ROSCA
103-02-04	R 2 - 1/4"	1/8" Gas
103-04-04	R 2 - 1/4"	1/4" Gas
103-06-04	R 2 - 1/4"	3/8" Gas
103-04-05	R 2 - 5/16"	1/4" Gas
103-06-05	R 2 - 5/16"	3/8" Gas
103-08-05	R 2 - 5/16"	1/2" Gas
103-06-06	R 2 - 3/8"	3/8" Gas
103-08-06	R 2 - 3/8"	1/2" Gas
103-08-08	R 2 - 1/2"	1/2" Gas
103-10-08	R 2 - 1/2"	5/8" Gas
103-12-08	R 2 - 1/2"	3/4" Gas
103-10-10	R 2 - 5/8"	5/8" Gas
103-12-10	R 2 - 5/8"	3/4" Gas
103-12-12	R 2 - 3/4"	3/4" Gas
103-16-12	R 2 - 3/4"	1" Gas
103-16-16	R 2 - 1"	1" Gas
103-20-20	R 2 - 1 1/4"	1 1/4" Gas
103-24-24	R 2 - 1 1/2"	1 1/2" Gas
103-32-32	R 2 - 2"	2" Gas

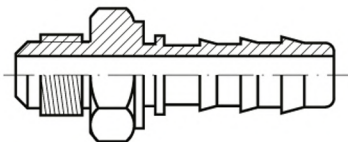

### RACOR MACHO JIC

CODIGO	Φ TUBO	ROSCA
106-02-04	R 2 - 1/4"	3/8" Jic
106-04-04	R 2 - 1/4"	7/16" Jic
106-05-04	R 2 - 1/4"	1/2" Jic
106-06-04	R 2 - 1/4"	9/16" Jic
106-08-04	R 2 - 1/4"	5/8" Jic
106-10-04	R 2 - 1/4"	3/4" Jic
106-04-05	R 2 - 5/16"	7/16" Jic
106-05-05	R 2 - 5/16"	1/2" Jic
106-08-05	R 2 - 5/16"	9/16" Jic
106-06-06	R 2 - 3/8"	9/16" Jic
106-10-06	R 2 - 3/8"	5/8" Jic
106-08-06	R 2 - 3/8"	3/4" Jic
106-12-06	R 2 - 3/8"	7/8" Jic
106-08-08	R 2 - 1/2"	3/4" Jic
106-10-08	R 2 - 1/2"	7/8" Jic
106-12-08	R 2 - 1/2"	1 1/16" Jic
106-10-10	R 2 - 5/8"	7/8" Jic
106-12-10	R 2 - 5/8"	1 1/16" Jic
106-12-12	R 2 - 3/4"	1 1/16" Jic
106-14-12	R 2 - 3/4"	1 3/16" Jic
106-16-12	R 2 - 3/4"	1 5/16" Jic
106-16-16	R 2 - 1"	1 5/16" Jic
106-20-20	R 2 - 1 1/4"	1 5/8" Jic
106-24-24	R 2 - 1 1/2"	1 7/8" Jic



## RACORES PRENSADOS SAE 100 - R-1 R-2

ESPIGA AMERICANA

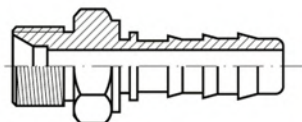

### RACOR MACHO METRICO

CODIGO	Φ TUBO	ROSCA	
105-02-04	R 2 - 1/4"	10/100	
105-04-04	R 2 - 1/4"	12/150	
105-06-04	R 2 - 1/4"	14/150	
105-08-04	R 2 - 1/4"	16/150	
105-06-05	R 2 - 5/16"	14/150	
105-08-05	R 2 - 5/16"	16/150	
105-10-05	R 2 - 5/16"	18/150	
105-12-05	R 2 - 5/16"	20/150	
105-08-06	R 2 - 3/8"	16/150	
105-10-06	R 2 - 3/8"	18/150	
105-12-06	R 2 - 3/8"	20/150	
105-14-06	R 2 - 3/8"	22/150	
105-12-08	R 2 - 1/2"	22/150	
105-13-08	R 2 - 1/2"	22/150	
105-16-08	R 2 - 1/2"	24/150	
105-18-08	R 2 - 1/2"	26/150	
105-14-10	R 2 - 5/8"	26/150	
105-16-10	R 2 - 5/8"	30/150	ASIENTO PLANO
105-20-10	R 2 - 5/8"	30/200	
105-20-12	R 2 - 3/4"	30/150	
105-22-12	R 2 - 3/4"	30/200	
105-23-12	R 2 - 3/4"	36/125	
105-24-12	R 2 - 3/4"	36/150	
105-25-12	R 2 - 3/4"	36/200	
105-24-16	R 2 - 1"	33/150	
105-26-16	R 2 - 1"	36/150	
105-28-16	R 2 - 1"	36/200	
105-25-16	R 2 - 1"	38/150	
105-30-16	R 2 - 1"	42/200	
105-25-20	R 2 - 1 1/4"	42/200	
105-28-20	R 2 - 1 1/4"	45/150	
105-35-20	R 2 - 1 1/4"	45/200	
105-38-20	R 2 - 1 1/4"	52/200	





**RACORES PRENSADOS SAE 100 - R-1 R-2**

**ESPIGA AMERICANA**

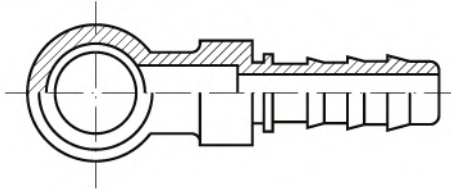

**RACOR ORIENTABLE GAS**

CODIGO	Φ TUBO	TORNILLO
107-04-04	R 2 - 1/4"	1/4" Gas
107-06-04	R 2 - 1/4"	3/8" Gas
107-04-05	R 2 - 5/16"	1/4" Gas
107-06-05	R 2 - 5/16"	3/8" Gas
107-05-06	R 2 - 3/8"	1/4" Gas
107-06-06	R 2 - 3/8"	3/8" Gas
107-08-06	R 2 - 3/8"	1/2" Gas
107-06-08	R 2 - 1/2"	3/8" Gas
107-08-08	R 2 - 1/2"	1/2" Gas
107-12-08	R 2 - 1/2"	3/4" Gas
107-08-10	R 2 - 5/8"	1/2" Gas
107-12-10	R 2 - 5/8"	3/4" Gas
107-12-12	R 2 - 3/4"	3/4" Gas
107-16-16	R 2 - 1"	1" Gas

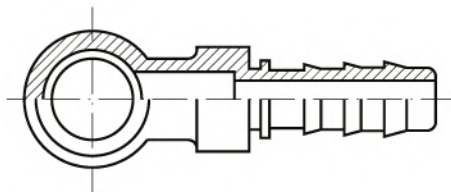

**RACOR ORIENTABLE METRICO**

CODIGO	Φ TUBO	TORNILLO
112-04-04	R 2 - 1/4"	10
112-06-04	R 2 - 1/4"	12
112-08-04	R 2 - 1/4"	14
112-05-05	R 2 5/16"	10
112-06-05	R 2 5/16"	12
112-08-05	R 2 5/16"	14
112-04-06	R 2 - 3/8"	14
112-06-06	R 2 - 3/8"	16
112-08-06	R 2 - 3/8"	18
112-06-08	R 2 - 1/2"	18
112-08-08	R 2 - 1/2"	22



**RACORES PRENSADOS SAE 100 - R-1 R-2**

**ESPIGA AMERICANA**

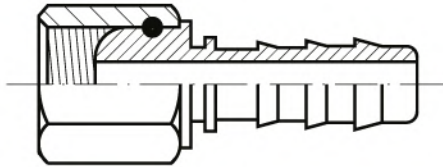

**RACOR HEMBRA GAS**

CODIGO	Φ TUBO	ROSCA
108-02-04	R 2 - 1/4"	1/8" Gas
108-04-04	R 2 - 1/4"	1/4" Gas
108-06-04	R 2 - 1/4"	3/8" Gas
108-04-05	R 2 - 5/16"	1/4" Gas
108-06-05	R 2 - 5/16"	3/8" Gas
108.08.05	R 2 - 5/16"	1/2" Gas
108-06-06	R 2 - 3/8"	3/8" Gas
108-08-06	R 2 - 3/8"	1/2" Gas
108-06-08	R 2 - 1/2"	3/8" Gas
108-08-08	R 2 - 1/2"	1/2" Gas
108-09-08	R 2 - 1/2"	5/8" Gas
108-12-08	R 2 - 1/2"	3/4" Gas
108.08.10	R 2 - 5/8"	1/2" Gas
108-10-10	R 2 - 5/8"	5/8" Gas
108-12-10	R 2 - 5/8"	3/4" Gas
108-08-12	R 2 - 3/4"	1/2" Gas
108-12-12	R 2 - 3/4"	3/4" Gas
108-16-12	R 2 - 3/4"	1" Gas
108-16-16	R 2 - 1"	1" Gas
108-20-20	R 2 - 1 1/4"	1 1/4" Gas
108-24-24	R 2 - 1 1/2"	1 1/2" Gas
108-32-32	R 2 - 2"	2" Gas

CODIGO	Φ TUBO	ROSCA
108-10-04	R 2 - 1/4"	1/4" Gas
108-12-04	R 2 - 5/16"	3/8" Gas
108-04-06	R 2 - 3/8"	3/8" Gas
108-10-06	R 2 - 3/8"	1/2" Gas
108-10-08	R 2 - 1/2"	1/2" Gas
108-08-10	R 2 - 5/8"	1/2" Gas
108-10-12	R 2 - 3/4"	3/4" Gas
108-10-16	R 2 - 1"	1" Gas
108-22-20	R 2 - 1 1/4"	1 1/4" Gas

**RACOR HEMBRA GAS ASIENTO PLANO**

**RACOR HEMBRA GAS "CONO JIC"**

CODIGO	Φ TUBO	ROSCA
108-05-04	R 2 - 1/4"	1/4" Gas
108-14-06	R 2 - 3/8"	3/8" Gas
108-14-08	R 2 - 1/2"	1/2" Gas
108-14-10	R 2 - 5/8"	3/4" Gas
108-15-12	R 2 - 3/4"	3/4" Gas

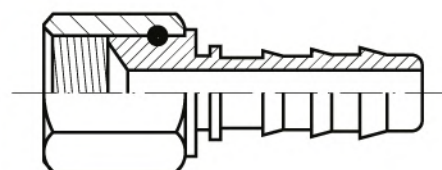



## RACORES PRENSADOS SAE 100 - R-1 R-2

ESPIGA AMERICANA

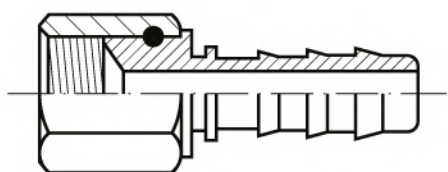

RACOR HEMBRA JIC

CODIGO	Φ TUBO	ROSCA
109-04-04	R 2 - 1/4"	7/16" Jic
109-05-04	R 2 - 1/4"	1/2" Jic
109-06-04	R 2 - 1/4"	9/16" Jic
109-07-04	R 2 - 1/4"	5/8" Jic
109-08-04	R 2 - 1/4"	3/4" Jic
109-05-05	R 2 - 5/16"	1/2" Jic
109-08-05	R 2 - 5/16"	9/16" Jic
109-10-05	R 2 - 5/16"	5/8" Jic
109-06-06	R 2 - 3/8"	9/16" Jic
109-07-06	R 2 - 3/8"	5/8" Jic
109-08-06	R 2 - 3/8"	3/4" Jic
109-10-06	R 2 - 3/8"	7/8" Jic
109-08-08	R 2 - 1/2"	3/4" Jic
109-10-08	R 2 - 1/2"	7/8" Jic
109-12-08	R 2 - 1/2"	1 1/16" Jic
109.08.10	R 2 - 5/8"	3/4" Jic
109-10-10	R 2 - 5/8"	7/8" Jic
109-12-10	R 2 - 5/8"	1 1/16" Jic
109-12-12	R 2 - 3/4"	1 1/16" Jic
109-14-12	R 2 - 3/4"	1 3/16" Jic
109-16-12	R 2 - 3/4"	1 5/16" Jic
109-14-16	R 2 - 1"	1 1/16" Jic
109-16-16	R 2 - 1"	1 5/16" Jic
109-20-20	R 2 - 1 1/4"	1 5/8" Jic
109-24-24	R 2 - 1 1/2"	1 7/8" Jic



## RACORES PRENSADOS SAE 100 - R-1 R-2

ESPIGA AMERICANA

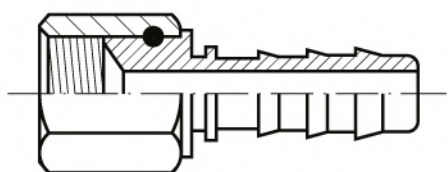

### RACOR HEMBRA METRICO

CODIGO	Φ TUBO	ROSCA	
110-02-04	R 2 - 1/4"	10/100	
110-04-04	R 2 - 1/4"	12/150	
110-06-04	R 2 - 1/4"	14/150	
110-08-04	R 2 - 1/4"	16/150	
110-10-04	R 2 - 1/4"	18/150	
110-06-05	R 2 - 5/16"	14/150	
110-08-05	R 2 - 5/16"	16/150	
110-10-05	R 2 - 5/16"	18/150	
110-08-06	R 2 - 3/8"	16/150	
110-10-06	R 2 - 3/8"	18/150	
110-12-06	R 2 - 3/8"	20/150	
110-14-06	R 2 - 3/8"	22/150	
110-13-08	R 2 - 1/2"	22/150	ASIENTO PLANO
110-14-08	R 2 - 1/2"	22/150	
110-16-08	R 2 - 1/2"	24/150	
110-18-08	R 2 - 1/2"	26/150	
110-16-10	R 2 - 5/8"	26/150	
110-18-10	R 2 - 5/8"	30/150	
110-20-10	R 2 - 5/8"	30/200	
110-20-12	R 2 - 3/4"	30/150	
110-22-12	R 2 - 3/4"	30/200	
110-23-12	R 2 - 3/4"	36/125	
110-24-12	R 2 - 3/4"	36/150	
110-25-12	R 2 - 3/4"	36/200	
110-24-16	R 2 - 1"	36/150	
110-28-16	R 2 - 1"	36/200	
110-25-16	R 2 - 1"	38/150	
110-30-16	R 2 - 1"	42/200	
110-25-20	R 2 - 1 1/4"	42/200	
110-30-20	R 2 - 1 1/4"	45/150	
110-35-20	R 2 - 1 1/4"	45/200	
110-38-20	R 2 - 1 1/4"	52/200	
110-36-24	R 2 - 1 1/2"	52/150	
110-38-24	R 2 - 1 1/2"	52/200	





**RACORES PRENSADOS SAE 100 - R-1 R-2**

**ESPIGA AMERICANA**

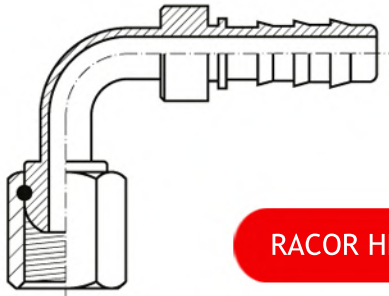

**RACOR HEMBRA CODO 90° GAS**

CODIGO	Φ TUBO	ROSCA
111-02-04	R 2 - 1/4"	1/8" Gas
111-04-04	R 2 - 1/4"	1/4" Gas
111-06-04	R 2 - 1/4"	3/8" Gas
111-04-05	R 2 - 5/16"	1/4" Gas
111-06-05	R 2 - 5/16"	3/8" Gas
111-08-05	R 2 - 5/16"	1/2" Gas
111-06-06	R 2 - 3/8"	3/8" Gas
111-08-06	R 2 - 3/8"	1/2" Gas
111-08-08	R 2 - 1/2"	1/2" Gas
111-10-08	R 2 - 1/2"	5/8" Gas
111-12-08	R 2 - 1/2"	3/4" Gas
111-10-10	R 2 - 5/8"	5/8" Gas
111-12-10	R 2 - 5/8"	3/4" Gas
111-10-12	R 2 - 3/4"	1/2" Gas
111-12-12	R 2 - 3/4"	3/4" Gas
111-16-12	R 2 - 3/4"	1" Gas
111-16-16	R 2 - 1"	1" Gas
111-20-20	R 2 - 1 1/4"	1 1/4" Gas
111-24-24	R 2 - 1 1/2"	1 1/2" Gas
111-32-32	R 2 - 2"	2" Gas

**RACOR HEMBRA CODO 65° GAS**

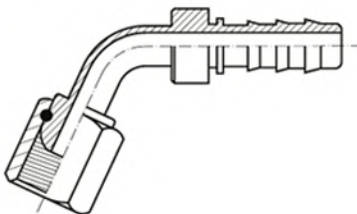

CODIGO	Φ TUBO	ROSCA
116-04-04	R 2 - 1/4"	1/4" Gas
116-06-04	R 2 - 1/4"	3/8" Gas
116-06-06	R 2 - 3/8"	3/8" Gas
116-08-06	R 2 - 3/8"	1/2" Gas
116-08-08	R 2 - 1/2"	1/2" Gas
116-10-10	R 2 - 5/8"	5/8" Gas
116-12-10	R 2 - 5/8"	3/4" Gas
116-12-12	R 2 - 3/4"	3/4" Gas
116-16-16	R 2 - 1"	1" Gas
116-20-20	R 2 - 1 1/4"	1 1/4" Gas





**RACORES PRENSADOS SAE 100 - R-1 R-2**

**ESPIGA AMERICANA**

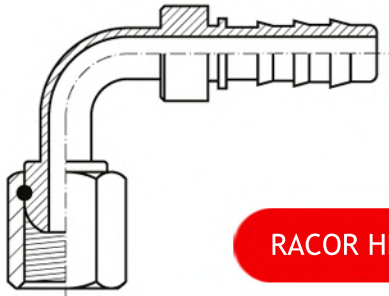

**RACOR HEMBRA CODO 90° METRICO**

CODIGO	Φ TUBO	ROSCA
120-03-04	R 2 - 1/4"	12/150
120-04-04	R 2 - 1/4"	14/150
120-05-04	R 2 - 1/4"	16/150
120-06-04	R 2 - 1/4"	18/150
120-05-06	R 2 - 3/8"	16/150
120-04-06	R 2 - 3/8"	18/150
120-06-06	R 2 - 3/8"	20/150
120-08-06	R 2 - 3/8"	22/150
120-08-08	R 2 - 1/2"	22/150
120-10-08	R 2 - 1/2"	24/150
120-12-08	R 2 - 1/2"	26/150
120-10-10	R 2 - 5/8"	26/150
120-12-10	R 2 - 5/8"	30/200
120-12-12	R 2 - 3/4"	30/150
120-14-12	R 2 - 3/4"	30/200
120-10-12	R 2 - 3/4"	36/125
120-18-12	R 2 - 3/4"	36/150
120-16-12	R 2 - 3/4"	36/200
120-16-16	R 2 - 1"	36/150
120-18-16	R 2 - 1"	36/200
120-20-16	R 2 - 1"	38/200

**RACOR HEMBRA CODO 65° METRICO**

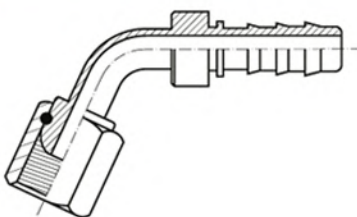

CODIGO	Φ TUBO	ROSCA
117-07-06	R 2 - 3/8"	22/150
117-08-08	R 2 - 1/2"	22/150
117-09-08	R 2 - 1/2"	26/150
117-10-10	R 2 - 5/8"	26/150
117-12-10	R 2 - 5/8"	30/200
117-14-12	R 2 - 3/4"	36/125
117-16-12	R 2 - 3/4"	30/200
117-16-16	R 2 - 3/4"	36/200



## RACORES PRENSADOS SAE 100 - R-1 R-2

ESPIGA AMERICANA

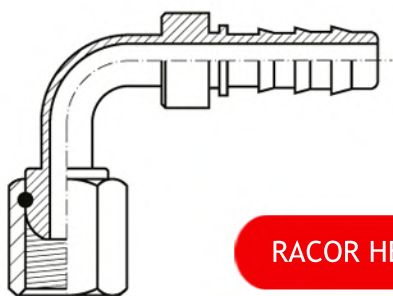

RACOR HEMBRA CODO 90° JIC

CODIGO	Φ TUBO	ROSCA
121-03-04	R 2 - 1/4"	7/16" Jic
121-04-04	R 2 - 1/4"	9/16" Jic
121-05-04	R 2 - 1/4"	1/2" Jic
121-06-04	R 2 - 1/4"	3/4" Jic
121-06-05	R 2 - 5/16"	9/16" Jic
121-06-06	R 2 - 3/8"	9/16" Jic
121-07-06	R 2 - 3/8"	5/8" Jic
121-08-06	R 2 - 3/8"	3/4" Jic
121-10-06	R 2 - 3/8"	7/8" Jic
121-08-08	R 2 - 1/2"	3/4" Jic
121-10-08	R 2 - 1/2"	7/8" Jic
121-12-08	R 2 - 1/2"	1 1/16" Jic
121-12-10	R 2 - 5/8"	7/8" Jic
121-10-10	R 2 - 5/8"	1 1/16" Jic
121-12-12	R 2 - 3/4"	1 1/16" Jic
121-16-12	R 2 - 3/4"	1 3/16" Jic
121-18-12	R 2 - 3/4"	1 5/16" Jic
121-14-16	R 2 - 1"	1 1/16" Jic
121-16-16	R 2 - 1"	1 5/16" Jic

RACOR HEMBRA CODO 65° JIC

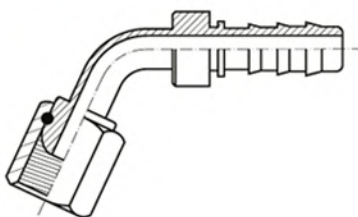

CODIGO	Φ TUBO	ROSCA
123-03-04	R 2 - 1/4"	7/16" Jic
123-04-04	R 2 - 1/4"	1/2" Jic
123-05-04	R 2 - 1/4"	9/16" Jic
123-06-05	R 2 - 5/16"	9/16" Jic
123-06-06	R 2 - 3/8"	9/16" Jic
123-08-06	R 2 - 3/8"	3/4" Jic
123.10.06	R 2 - 3/8"	7/8" Jic
123-08-08	R 2 - 1/2"	7/8" Jic
123-08-10	R 2 - 5/8"	7/8" Jic
123-12-12	R 2 - 3/4"	1 1/16" Jic
123-16-12	R 2 - 3/4"	1 3/16" Jic
123-18-12	R 2 - 3/4"	1 5/16" Jic
123-14-16	R 2 - 1"	1 5/16" Jic



**RACORES PRENSADOS SAE 100 - R-1 R-2**

**ESPIGA AMERICANA**

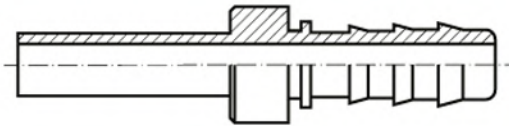

**RACOR TUBULAR METRICO**

CODIGO	Φ TUBO	Φ TUBO
122-01-03	R 2 - 3/16"	6 mm
122-01-04	R 2 - 1/4"	4 mm
122-02-04	R 2 - 1/4"	6 mm
122-04-04	R 2 - 1/4"	8 mm
122-06-04	R 2 - 1/4"	10 mm
122-08-04	R 2 - 1/4"	12 mm
122-07-04	R 2 - 1/4"	13,5 mm
122-04-05	R 2 - 5/16"	8 mm
122-06-05	R 2 - 5/16"	10 mm
122-08-05	R 2 - 5/16"	12 mm
122-10-05	R 2 - 5/16"	14 mm
122-04-06	R 2 - 3/8"	8 mm
122-06-06	R 2 - 3/8"	10 mm
122-08-06	R 2 - 3/8"	12 mm
122-10-06	R 2 - 3/8"	14 mm
122-08-08	R 2 - 1/2"	12 mm
122-09-08	R 2 - 1/2"	14 mm
122-10-08	R 2 - 1/2"	15 mm
122-12-08	R 2 - 1/2"	16 mm
122-13-08	R 2 - 1/2"	18 mm
122-14-08	R 2 - 1/2"	20 mm
122-16-08	R 2 - 1/2"	21,2 mm
122-06-10	R 2 - 5/8"	16 mm
122-08-10	R 2 - 5/8"	18 mm
122-10-10	R 2 - 5/8"	20 mm
122-12-10	R 2 - 5/8"	25 mm
122-10-12	R 2 - 3/4"	20 mm
122-12-12	R 2 - 3/4"	22 mm
122-16-12	R 2 - 3/4"	25 mm
122-16-16	R 2 - 1"	30 mm

**RACOR TUBULAR METRICO CODO 90°**

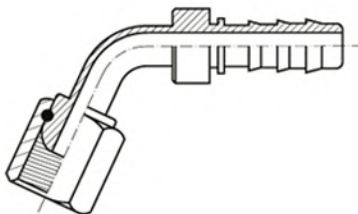

CODIGO	Φ TUBO	Φ TUBO
124-02-04	R 2 - 1/4"	6 mm
124-06-04	R 2 - 1/4"	10 mm
124-06-06	R 2 - 3/8"	10 mm
124-08-06	R 2 - 3/8"	12 mm
124-10-08	R 2 - 1/2"	15 mm



## RACORES PRENSADOS SAE 100 - R-1 R-2

ESPIGA AMERICANA

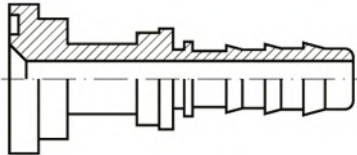

### RACOR TUBULAR METRICO

CODIGO	Φ TUBO	Φ PLATINA
113-08-08	R 2 - 1/2"	30,22 mm
113-09-08	R 2 - 1/2"	31,7 mm
113-10-08	R 2 - 1/2"	38,10 mm
113-12-12	R 2 - 3/4"	38,10 mm
113-14-12	R 2 - 3/4"	42,7 mm
113-16-12	R 2 - 3/4"	44,45 mm
113-16-16	R 2 - 1"	44,45 mm
113-20-16	R 2 - 1"	50,80 mm
113-16-20	R 2 - 1 1/4"	44,45 mm
113-20-20	R 2 - 1 1/4"	50,80 mm
113-24-20	R 2 - 1 1/4"	60,45 mm

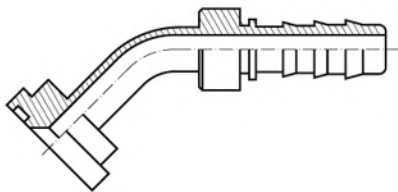

### PLATINA 45°

CODIGO	Φ TUBO	Φ PLATINA
114-08-08	R 2 - 1/2"	30,22 mm
114-10-08	R 2 - 1/2"	38,10 mm
114-12-12	R 2 - 3/4"	38,10 mm
114-16-16	R 2 - 1"	44,45 mm
114-20-16	R 2 - 1"	50,80 mm
114-16-20	R 2 - 1 1/4"	44,45 mm
114-20-20	R 2 - 1 1/4"	50,80 mm
114-24-20	R 2 - 1 1/4"	60,45 mm

### PLATINA 90°

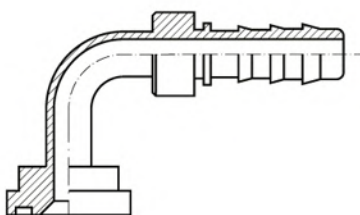

CODIGO	Φ TUBO	Φ PLATINA
115-08-08	R 2 - 1/2"	30,22 mm
115-10-08	R 2 - 1/2"	38,10 mm
115-12-12	R 2 - 3/4"	38,10 mm
115-16-12	R 2 - 3/4"	44,45 mm
115-20-12	R 2 - 3/4"	50,80 mm
115-16-16	R 2 - 1"	44,45 mm
115-20-16	R 2 - 1"	50,80 mm
115-16-20	R 2 - 1 1/4"	44,45 mm
115-20-20	R 2 - 1 1/4"	50,80 mm
115-24-20	R 2 - 1 1/4"	60,45 mm





**RACORES PRENSADOS SAE 100 - R-1 R-2**

**ESPIGA AMERICANA**

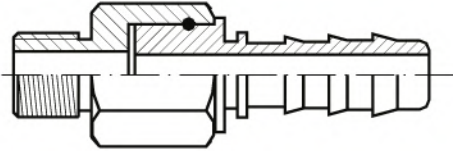

**RACOR MACHO GIRATORIO RECTO**

CODIGO	Φ TUBO	ROSCA
224-10-08	R 2 - 1/2"	7/8" SAE -14 H.
224-10-10	R 2 - 5/8"	7/8" SAE -14 H.

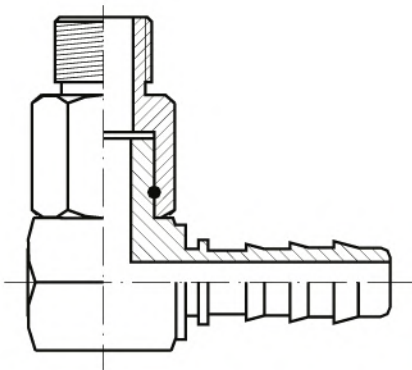

**RACOR MACHO GIRATORIO CODO 90°**

CODIGO	Φ TUBO	ROSCA
225-08-08	R 2 - 1/2"	7/8" SAE -14 H.

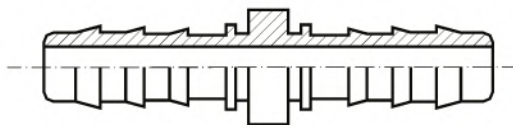

**RACOR TUBO - TUBO**

CODIGO	Φ TUBO	Φ TUBO
224-04-04	R 2 - 1/4"	R 2 - 1/4"
224-05-05	R 2 - 5/16"	R 2 - 5/16"
224-06-06	R 2 - 3/8"	R 2 - 3/8"
224-08-08	R 2 - 1/2"	R 2 - 1/2"
224-11-10	R 2 - 5/8"	R 2 - 5/8"
224-12-12	R 2 - 3/4"	R 2 - 3/4"





**RACORES PRENSADOS SAE 100 - R-1 R-2**

**ESPIGA AMERICANA**

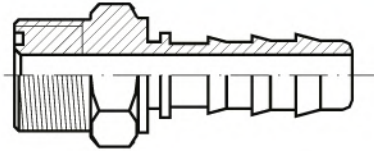

**RACOR MACHO ORFS**

CODIGO	Φ TUBO	ROSCA
104-04-04	R 2 - 1/4"	9/16" - 18
104-06-06	R 2 - 3/8"	11/16" - 16
104-08-06	R 2 - 3/8"	13/16" - 16
104-08-08	R 2 - 1/2"	13/16" - 16
104-10-08	R 2 - 1/2"	1" - 14
104-10-10	R 2 - 5/8"	1" - 14
104-12-10	R 2 - 5/8"	1 3/16" - 12
104-12-12	R 2 - 3/4"	1 3/16" - 12
104-16-12	R 2 - 3/4"	1 7/16" - 12
104-16-16	R 2 - 1"	1 7/16" - 12
104-18-16	R 2 - 1"	1 11/16" - 12
104-16-20	R 2 - 1 1/4"	1 7/16" - 12
104-20-20	R 2 - 1 1/4"	1 11/16" - 12

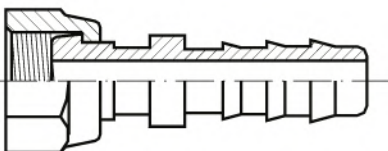

**RACOR HEMBRA ORFS**

CODIGO	Φ TUBO	ROSCA
125-04-04	R 2 - 1/4"	9/16" - 18
125-06-06	R 2 - 3/8"	11/16" - 16
125-08-06	R 2 - 3/8"	13/16" - 16
125-08-08	R 2 - 1/2"	13/16" - 16
125-10-08	R 2 - 1/2"	1" - 14
125-10-10	R 2 - 5/8"	1" - 14
125-12-10	R 2 - 5/8"	1 3/16" - 12
125-12-12	R 2 - 3/4"	1 3/16" - 12
125-16-12	R 2 - 3/4"	1 7/16" - 12
125-16-16	R 2 - 1"	1 7/16" - 12
125-18-16	R 2 - 1"	1 11/16" - 12
125-20-20	R 2 - 1 1/4"	1 11/16" - 12



**RACORES PRENSADOS SAE 100 - R-1 R-2**

**ESPIGA AMERICANA**

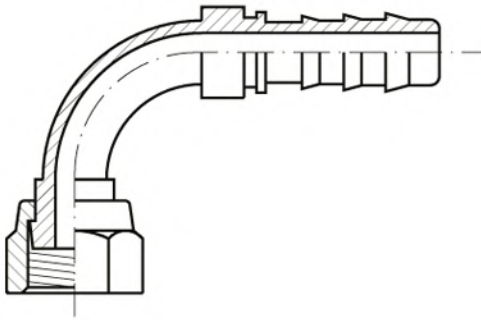

**RACOR HEMBRA CODO 90° ORFS**

CODIGO	Φ TUBO	ROSCA
126-04-04	R 2 - 1/4"	9/16" - 18
126-06-06	R 2 - 3/8"	11/16" - 16
126.08.06	R 2 - 3/8"	13/16" - 16
126-08-08	R 2 - 1/2"	13/16" - 16
126-10-08	R 2 - 1/2"	1" - 14
126-10-10	R 2 - 5/8"	1" - 14
126-12-10	R 2 - 5/8"	1 3/16" - 12
126-12-12	R 2 - 3/4"	1 3/16" - 12
126-16-12	R 2 - 3/4"	1 7/16" - 12
126-16-16	R 2 - 1"	1 7/16" - 12

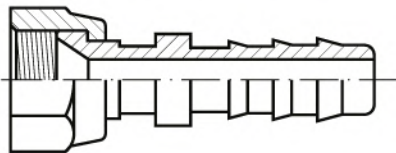

**RACOR HEMBRA KOMATSU**

CODIGO	Φ TUBO	ROSCA
110.40.06	R 2 - 3/8"	18/150
110.50.08	R 2 - 1/2"	22/150
110.60.08	R 2 - 1/2"	24/150
110.60.10	R 2 - 5/8"	24/150
110.70.12	R 2 - 3/4"	30/150



## RACORES PRENSADOS SAE 100 - R-9

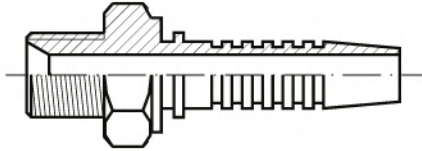

**RACOR MACHO GAS**

CODIGO	Φ TUBO	ROSCA
186-08-08	R 9 - 1/2"	1/2" GAS
186-10-10	R 9 - 5/8"	5/8" GAS
186-12-10	R 9 - 5/8"	3/4" GAS
186-12-12	R 9 - 3/4"	3/4" GAS
186-16-16	R 9 - 1"	1" GAS
186-20-20	R 9 - 1 1/4"	1 1/4" GAS
186-24-24	R 9 - 1 1/2"	1 1/2" GAS

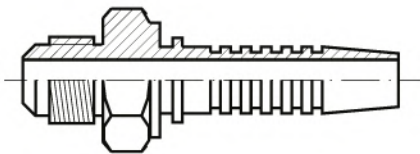

**RACOR MACHO JIC**

CODIGO	Φ TUBO	ROSCA
187-08-08	R 9 - 1/2"	3/4" JIC
187-10-08	R 9 - 1/2"	7/8" JIC
187-12-10	R 9 - 5/8"	1 1/16" JIC
187-12-12	R 9 - 3/4"	1 1/16" JIC
187-16-12	R 9 - 3/4"	1 3/16" JIC
187-14-12	R 9 - 3/4"	1 5/16" JIC
187-16-16	R 9 - 1"	1 5/16" JIC
187-20-20	R 9 - 1 1/4"	1 5/8" JIC

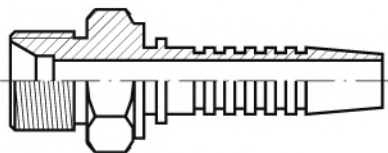

**RACOR HEMBRA KOMATSU**

CODIGO	Φ TUBO	ROSCA
188-13-08	R 9 - 1/2"	22-150
188-16-08	R 9 - 1/2"	24-150
188-24-12	R 9 - 3/4"	30-200
188-20-12	R 9 - 3/4"	30-150
188-25-12	R 9 - 3/4"	36-200
188-24-16	R 9 - 1"	36-150
188-28-16	R 9 - 1"	36-200
188-25-16	R 9 - 1"	38-150
188-30-16	R 9 - 1"	42-200
188-28-20	R 9 - 1 1/4"	42-200
188-30-20	R 9 - 1 1/4"	45-150
188-32-20	R 9 - 1 1/4"	45-200
188-38-20	R 9 - 1 1/4"	52-200



## RACORES PRENSADOS SAE 100 - R-9

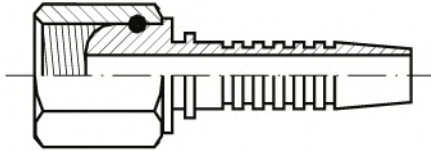

**RACOR HEMBRA GAS**

CODIGO	Φ TUBO	ROSCA
189-08-08	R 9 - 1/2"	1/2" GAS
189-10-10	R 9 - 5/8"	5/8" GAS
189-12-12	R 9 - 3/4"	3/4" GAS
189-16-12	R 9 - 3/4"	1" GAS
189-16-16	R 9 - 1"	1" GAS
189-20-20	R 9 - 1 1/4"	1 1/4" GAS
189-24-24	R 9 - 1 1/2"	1 1/2" GAS

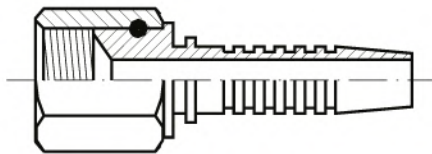

**RACOR HEMBRA JIC**

CODIGO	Φ TUBO	ROSCA
190-08-08	R 9 - 1/2"	3/4" JIC
190-10-08	R 9 - 1/2"	7/8" JIC
190-12-10	R 9 - 5/8"	1 1/16" JIC
190-10-10	R 9 - 5/8"	1 5/16" JIC
190-12-12	R 9 - 3/4"	1 1/16" JIC
190-16-12	R 9 - 3/4"	1 3/16" JIC
190-14-12	R 9 - 3/4"	1 5/16" JIC
190-16-16	R 9 - 1"	1 5/16" JIC
190-20-20	R 9 1 1/4"	1 5/8" JIC

**RACOR HEMBRA METRICO**

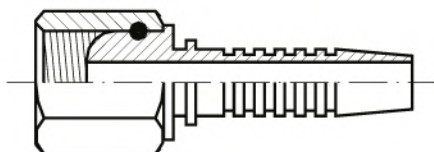

CODIGO	Φ TUBO	ROSCA
191-13-08	R 9 - 1/2"	22-150
191-16-08	R 9 - 1/2"	24-150
191-20-12	R 9 - 3/4"	30-150
191-18-12	R 9 - 3/4"	30-200
191-24-12	R 9 - 3/4"	36-150
191-22-12	R 9 - 3/4"	36-200
191-24-16	R 9 - 1"	36-150
191-28-16	R 9 - 1"	36-200
191-25-16	R 9 - 1"	38-150
191-30-16	R 9 - 1"	42-200
191-25-20	R 9 1 1/4"	42-200
191-30-20	R 9 1 1/4"	45-150
191-35-20	R 9 1 1/4"	45-200
191-38-20	R 9 1 1/4"	52-200
191-40-24	R 9 1 1/2"	52-150
191-42-24	R 9 1 1/2"	52-200





## RACORES PRENSADOS SAE 100 - R-9

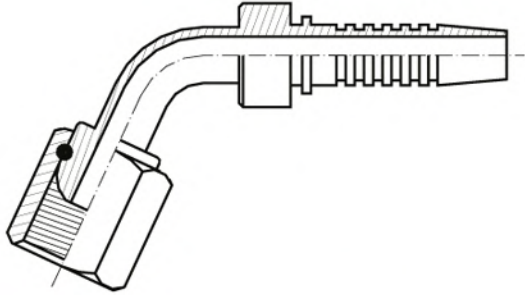

### RACOR HEMBRA 65° GAS

CODIGO	Φ TUBO	ROSCA
196-08-08	R 9 - 1/2"	1/2" GAS
196-12-12	R 9 - 3/4"	3/4" GAS
196-16-16	R 9 - 1"	1" GAS
196-20-20	R 9 - 1 1/4"	1 1/4" GAS

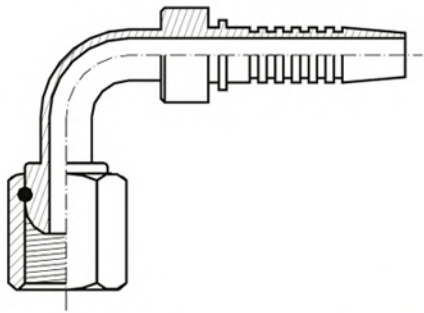

### RACOR HEMBRA 90° METRICO

CODIGO	Φ TUBO	ROSCA
197-08-08	R 9 - 1/2"	24-150
197-10-10	R 9 - 5/8"	30-200
197-24-12	R 9 - 3/4"	30-150
197-20-12	R 9 - 3/4"	30-200
197-26-12	R 9 - 3/4"	36-150
197-28-12	R 9 - 3/4"	36-200
197-24-16	R 9 - 1"	36-150
197-28-16	R 9 - 1"	36-200





## RACORES PRENSADOS SAE 100 - R-9

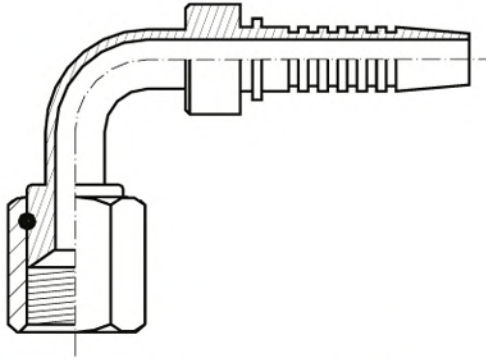

**RACOR HEMBRA 90° JIC**

CODIGO	Φ TUBO	ROSCA
198-12-12	R 9 - 3/4"	1 1/16" JIC
198-14-12	R 9 - 3/4"	1 5/16" JIC
198-16-16	R 9 - 1"	1 5/16" JIC

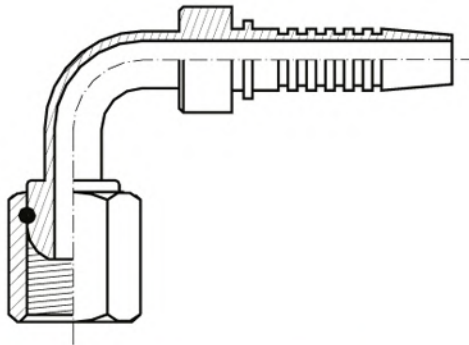

**RACOR HEMBRA 90° GAS**

CODIGO	Φ TUBO	ROSCA
192-08-08	R 9 - 1/2"	1/2" GAS
192-12-12	R 9 - 3/4"	3/4" GAS
192-16-16	R 9 - 1"	1" GAS
192-20-20	R 9 - 1 1/4"	1 1/4" GAS
192-24-24	R 9 - 1 1/2"	1 1/2" GAS



## RACORES PRENSADOS SAE 100 - R-9

### RACOR PLATINA RECTA

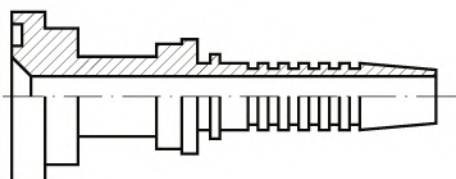

ALTO PLATINA 10mm

CODIGO	Φ TUBO	Φ PLATINA
193-08-08	R 9 - 1/2"	30,20 mm
193-09-08	R 9 - 1/2"	31,7 mm
193-12-12	R 9 - 3/4"	38,10 mm
193-14-12	R 9 - 3/4"	41,70 mm
193-16-12	R 9 - 3/4"	44,45 mm
193-18-12	R 9 - 3/4"	50,80 mm
193-16-16	R 9 - 1"	44,45 mm
193-18-16	R 9 - 1"	47,70 mm
193-20-16	R 9 - 1"	50,80 mm
193-16-20	R 9 - 1 1/4"	44,45 mm
193-20-20	R 9 - 1 1/4"	50,80 mm
193-24-20	R 9 - 1 1/4"	60,45 mm
193-26-20	R 9 - 1 1/4"	63,50 mm

### RACOR PLATINA 65°

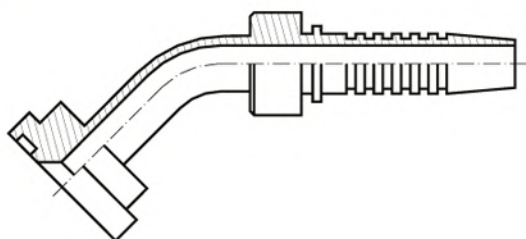

ALTO PLATINA 10mm

CODIGO	Φ TUBO	Φ PLATINA
194-12-12	R 9 - 3/4"	38,10 mm
194-16-12	R 9 - 3/4"	44,45 mm
194-16-16	R 9 - 1"	44,45 mm
194-18-16	R 9 - 1"	50,80 mm
194-16-20	R 9 - 1 1/4"	44,45 mm
194-20-20	R 9 - 1 1/4"	50,80 mm
194-24-20	R 9 - 1 1/4"	60,45 mm

### RACOR PLATINA 90°

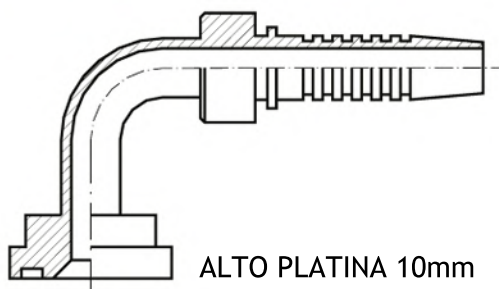

ALTO PLATINA 10mm

CODIGO	Φ TUBO	Φ PLATINA
195-08-08	R 9 - 1/2"	30,22 mm
195-12-12	R 9 - 3/4"	38,10 mm
195-14-12	R 9 - 3/4"	41,30 mm
195-16-12	R 9 - 3/4"	44,45 mm
195-18-12	R 9 - 3/4"	50,80 mm
195.14.16	R 9 - 1"	41,70 mm
195-16-16	R 9 - 1"	44,45 mm
195-20-16	R 9 - 1"	50,80 mm
195-22-16	R 9 - 1"	60,40 mm
195-16-20	R 9 - 1 1/4"	44,45 mm
195-20-20	R 9 - 1 1/4"	50,80 mm
195-24-20	R 9 - 1 1/4"	60,45 mm



## RACORES PRENSADOS SAE 100 - R-9

### RACOR BRIDA RECTA FIJA - TUBO R9

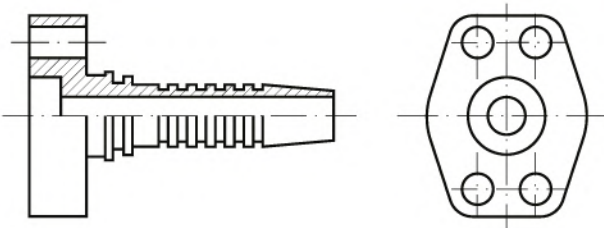

#### CODIGO

132-08-08  
132-10-10  
132-12-12  
132-16-16  
132-20-20

#### Φ TUBO

R 9 - 1/2"  
R 9 - 5/8"  
R 9 - 3/4"  
R 9 - 1"  
R 9 - 1 1/4"

### RACOR BRIDA RECTA GIRATORIA - TUBO R9

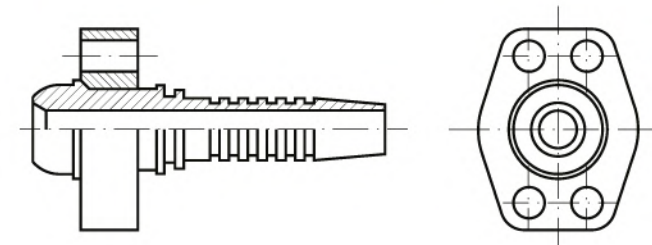

#### CODIGO

133-08-08  
133-10-10  
133-12-12  
133-16-16  
133-20-20

#### Φ TUBO

R 9 - 1/2"  
R 9 - 5/8"  
R 9 - 3/4"  
R 9 - 1"  
R 9 - 1 1/4"

### RACOR BRIDA CODO 90° GIRATORIA - TUBO R9

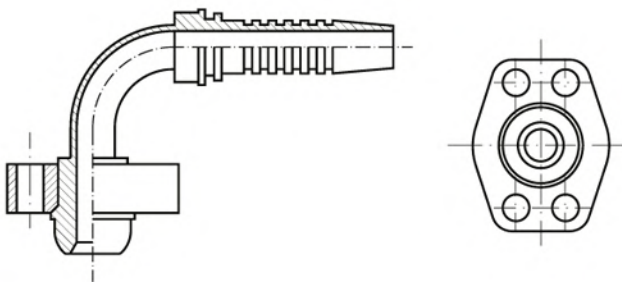

#### CODIGO

134-08-08  
134-10-10  
134-12-12  
134-16-16  
134-20-20

#### Φ TUBO

R 9 - 1/2"  
R 9 - 5/8"  
R 9 - 3/4"  
R 9 - 1"  
R 9 - 1 1/4"



## RACORES PRENSADOS SAE 100 - R-9

### RACOR MACHO ORS

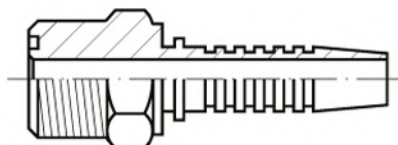

CODIGO	Φ TUBO	ROSCA
185-04-04	R 9 - 1/4"	9/16" - 18
185-06-06	R 9 - 3/8"	11/16" - 16
185-08-08	R 9 - 1/2"	13/16" - 16
185-10-08	R 9 - 1/2"	1" - 14
185-10-10	R 9 - 5/8"	1" - 14
185-12-10	R 9 - 5/8"	1 3/16" - 12
185-12-12	R 9 - 3/4"	1 3/16" - 12
185-16-12	R 9 - 3/4"	1 7/16" - 12
185-16-16	R 9 - 1"	1 7/16" - 12
185-20-20	R 9 - 1 1/4"	1 11/16" - 12

### RACOR HEMBRA ORS

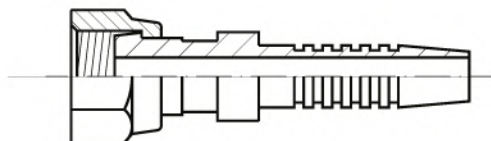

CODIGO	Φ TUBO	ROSCA
184-04-04	R 9 - 1/4"	9/16" - 18
184-06-06	R 9 - 3/8"	11/16" - 16
184-08-08	R 9 - 1/2"	13/16" - 16
184-10-08	R 9 - 1/2"	1" - 14
184-10-10	R 9 - 5/8"	1" - 14
184-12-10	R 9 - 5/8"	1 3/16" - 12
184-12-12	R 9 - 3/4"	1 3/16" - 12
184-16-12	R 9 - 3/4"	1 7/16" - 12
184-16-16	R 9 - 1"	1 7/16" - 12
184-20-20	R 9 - 1 1/4"	1 11/16" - 12





## RACORES PRENSADOS SAE 100 - R-9

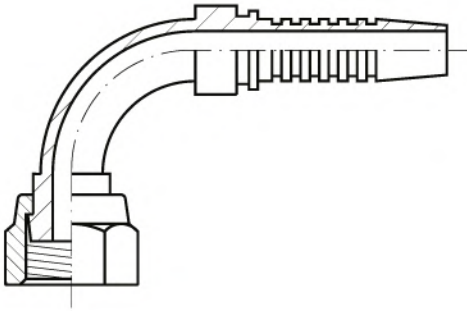

### RACOR HEMBRA CODO 90° ORFS

CODIGO	Φ TUBO	ROSCA
199-06-06	R 9 - 3/8"	11/16" - 16
199-08-08	R 9 - 1/2"	13/16" - 16
199-10-08	R 9 - 1/2"	1" - 14
199-10-10	R 9 - 5/8"	1" - 14
199-12-10	R 9 - 5/8"	1 3/16" - 12
199-12-12	R 9 - 3/4"	1 3/16" - 12
199-16-12	R 9 - 3/4"	1 7/16" - 12
199-16-16	R 9 - 1"	1 7/16" - 12

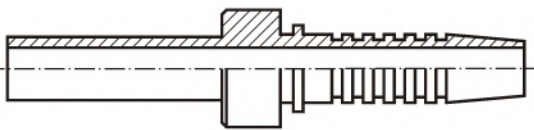

### RACOR TUBULAR METRICO

CODIGO	Φ TUBO	Φ TUBO
171-20-10	R 9 - 5/8"	T 20
171-20-12	R 9 - 3/4"	T 20
171-27-16	R 9 - 1"	T 24
171-28-16	R 9 - 1"	T 28
171-30-20	R 9 - 1 1/4"	T 30





## RACORES PRENSADOS SAE 100 - R-9

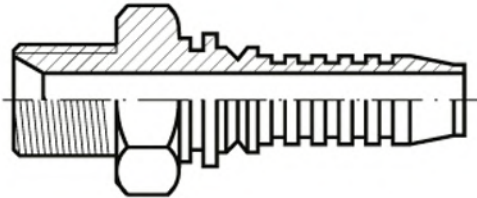

RACOR HEMBRA CODO 90° ORFS

CODIGO	Φ TUBO	ROSCA
193-01-16	R 13 - 1"	1" GAS
193-01-20	R 13 - 1 1/4"	1 1/4" GAS
193-01-24	R 13 - 1 1/2"	1 1/2" GAS

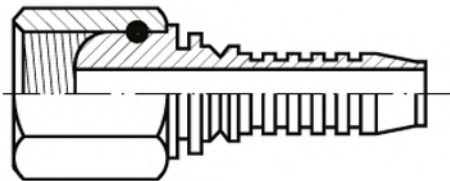

RACOR HEMBRA GAS S-6000 PSI (MULTIESPIRAL)

CODIGO	Φ TUBO	ROSCA
194-01-12	R 13 - 3/4"	3/4" GAS
194-01-16	R 13 - 1"	1" GAS
194-01-20	R 13 - 1 1/4"	1 1/4" GAS
194-01-24	R 13 - 1 1/2"	1 1/2" GAS

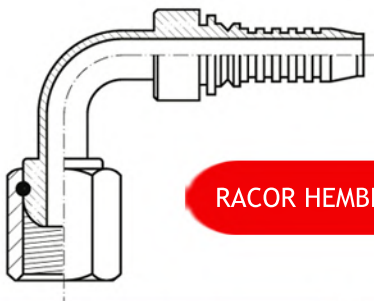

RACOR HEMBRA CODO 90° GAS S-6000 PSI (MULTIESPIRAL)

CODIGO	Φ TUBO	ROSCA
195-01-12	R 13 - 3/4"	3/4" GAS
195-01-16	R 13 - 1"	1" GAS
195-01-20	R 13 - 1 1/4"	1 1/4" GAS
195-01-24	R 13 - 1 1/2"	1 1/2" GAS



## RACORES PRENSADOS SAE 100 - R-13

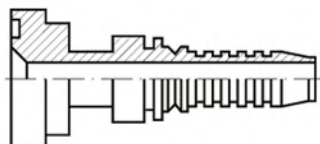

**RACOR PLATINA RECTA  
CATERPILLAR S-6000 PSI (MULTIESPIRAL)**

CODIGO	Φ TUBO	Φ PLATINA	ALTO PLATINA = 14 mm
193-41-12	R 13 - 3/4"	41,3 mm	
193-47-12	R 13 - 3/4"	47,6 mm	
193-41-16	R 13 - 1"	41,3 mm	
193-47-16	R 13 - 1"	47,6 mm	
193-54-16	R 13 - 1"	54 mm	
193-54-20	R 13 - 1 1/4"	54 mm	
193-63-20	R 13 - 1 1/4"	63,5 mm	
193-63-24	R 13 - 1 1/2"	63,5 mm	

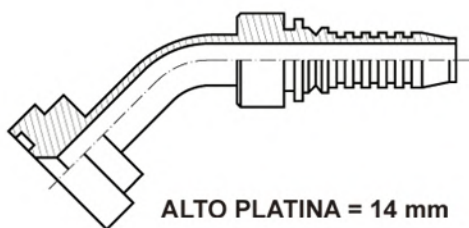

**RACOR PLATINA CODO 45°  
CATERPILLAR S-6000 PSI (MULTIESPIRAL)**

ALTO PLATINA = 14 mm

CODIGO	Φ TUBO	Φ PLATINA
194-41-12	R 13 - 3/4"	41,3 mm
194-47-12	R 13 - 3/4"	47,6 mm
194-47-16	R 13 - 1"	47,6 mm
194-54-16	R 13 - 1"	54 mm
194-54-20	R 13 - 1 1/4"	54 mm
194-63-20	R 13 - 1 1/4"	63,5 mm
194-63-24	R 13 - 1 1/2"	63,5 mm

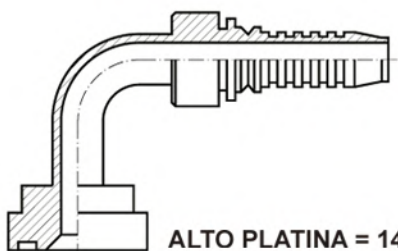

**RACOR PLATINA CODO 90°  
CATERPILLAR S-6000 PSI (MULTIESPIRAL)**

ALTO PLATINA = 14 mm

CODIGO	Φ TUBO	Φ PLATINA
195-41-12	R 13 - 3/4"	41,3 mm
195-47-12	R 13 - 3/4"	47,6 mm
195-41-16	R 13 - 1"	41,3 mm
195-47-16	R 13 - 1"	47,6 mm
195-54-16	R 13 - 1"	54 mm
195-41-20	R 13 - 1 1/4"	41,3 mm
195-54-20	R 13 - 1 1/4"	54 mm
195-63-20	R 13 - 1 1/4"	63,5 mm
195-63-24	R 13 - 1 1/2"	63,5 mm



## CASQUILLOS PARA PRENSAR

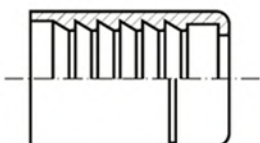

**SAE 100-R-1**

### CODIGO

118-00-03  
118-00-04  
118-00-05  
118-00-06  
118-00-08  
118-00-10  
118-00-12  
118-00-16  
118-00-20  
118-00-24  
118-00-32

### PARA TUBO

R-1 3/16"  
R-1 y R-5 1/4"  
R-1 y R-5 5/16"  
R-1 y R-5 3/8"  
R-1 y R-5 1/2"  
R-1 y R-5 5/8"  
R-1 y R-5 3/4"  
R-1 y R-5 1"  
R-1 y R-5 1 1/4"  
R-1 y R-5 1 1/2"  
R-1 y R-5 2"

**SAE 100 -R-7 TERMOPLASTICO**

119-00-04  
119-00-05  
119-00-06

R-7 1/4"  
R-7 5/16"  
R-7 3/8"

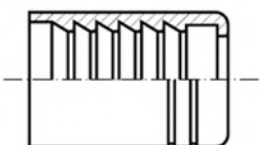

**SAE 100 R-2**

### CODIGO

220-00-04  
220-00-05  
220-00-06  
220-00-08  
220-00-10  
220-00-12  
220-00-16  
220-00-20  
220-00-24  
220-00-32

### PARA TUBO

R-2 1/4"  
R-2 5/16"  
R-2 3/8"  
R-2 1/2"  
R-2 5/8"  
R-2 3/4"  
R-2 1"  
R-2 1 1/4"  
R-2 1 1/2"  
R-2 2"

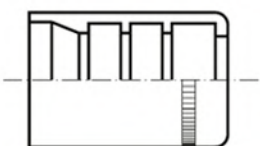

**SAE 100 - R-9**

### CODIGO

920-00-08  
920-00-10  
920-00-12  
920-00-16  
920-00-20  
920-00-24  
920-0032

### PARA TUBO

R-9 1/2"  
R-9 5/8"  
R-9 3/4"  
R-9 1"  
R-9 1 1/4"  
R-9 1 1/2"  
R-9 2"

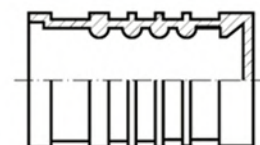

**SAE 100-R-13 (MULTIESPIRAL)**

### CODIGO

920-01-12  
920-01-16  
920-01-20  
920-01-24

### PARA TUBO

R-13 3/4"  
R-13 1"  
R-13 1 1/4"  
R-13 1 1/2"



## RACORES DESMONTABLES SAE 100 - R-2

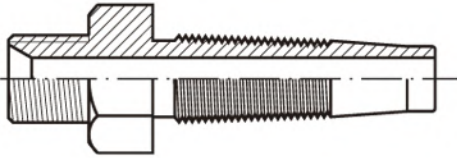

### RACOR MACHO CILINDRICO GAS (BSP)

CODIGO	Φ TUBO	ROSCA
203-04-04	R 2 - 1/4"	1/4" Gas 19
203-06-04	R 2 - 1/4"	3/8" Gas 19
203-06-06	R 2 - 3/8"	3/8" Gas 19
203-08-06	R 2 - 3/8"	1/2" Gas 14
203-08-08	R 2 - 1/2"	1/2" Gas 14
203-10-08	R 2 - 1/2"	5/8" Gas 14
203-10-10	R 2 - 5/8"	5/8" Gas 14
203-12-10	R 2 - 5/8"	3/4" Gas 14
203-12-12	R 2 - 3/4"	3/4" Gas 14
203-16-12	R 2 - 3/4"	1" Gas 11
203-16-16	R 2 - 1"	1" Gas 11

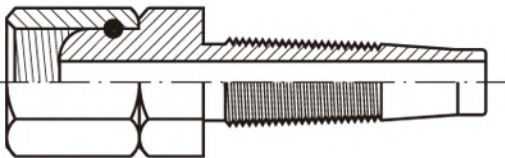

### RACOR TUERCA GIRATORIA GAS (BSP)

CODIGO	Φ TUBO	ROSCA
208-04-04	R 2 - 1/4"	1/4" Gas 19
208-06-04	R 2 - 1/4"	3/8" Gas 19
208-06-06	R 2 - 3/8"	3/8" Gas 19
208-08-06	R 2 - 3/8"	1/2" Gas 14
208-06-08	R 2 - 1/2"	3/8" GAS 19
208-08-08	R 2 - 1/2"	1/2" Gas 14
208-10-08	R 2 - 1/2"	5/8" Gas 14
208-12-08	R 2 - 1/2"	3/4" Gas 14
208-10-10	R 2 - 5/8"	5/8" Gas 14
208-12-10	R 2 - 5/8"	3/4" Gas 14
208-12-12	R 2 - 3/4"	3/4" Gas 14
208-16-12	R 2 - 3/4"	1" Gas 11
208-16-16	R 2 - 1"	1" Gas 11





## RACORES DESMONTABLES SAE 100 - R-2

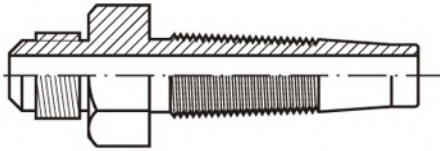

RACOR MACHO CILINDRICO SAE (JIC)

CODIGO	Φ TUBO	ROSCA
206-04-04	R 2 - 1/4"	7/16" - 20h
206-05-04	R 2 - 1/4"	1/2" - 20h
206-06-04	R 2 - 1/4"	9/16" - 18h
206-08-04	R 2 - 1/4"	5/8" - 18h
206-06-06	R 2 - 3/8"	9/16" - 16h
206-04-06	R 2 - 3/8"	5/8" - 18h
206-08-06	R 2 - 3/8"	3/4" - 16h
206-10-06	R 2 - 3/8"	7/8" - 14h
206-08-08	R 2 - 1/2"	3/4" - 16h
206-10-08	R 2 - 1/2"	7/8" - 14h
206-10-10	R 2 - 5/8"	7/8" - 14h
206-12-10	R 2 - 5/8"	1 1/16" - 12h
206-12-12	R 2 - 3/4"	1 1/16" - 12h
206-14-12	R 2 - 3/4"	1 3/16" - 12h
206-16-12	R 2 - 3/4"	1 5/16" - 12h
206-16-16	R 2 - 1"	1 5/16" - 12h

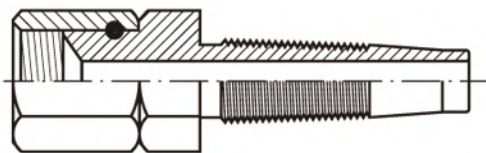

RACOR TUERCA GIRATORIA SAE (JIC)

CODIGO	Φ TUBO	ROSCA
209-04-04	R 2 - 1/4"	7/16" - JIC
209-05-04	R 2 - 1/4"	1/2" - JIC
209-06-04	R 2 - 1/4"	9/16" - JIC
209-06-06	R 2 - 3/8"	9/16" - JIC
209-08-06	R 2 - 3/8"	3/4" - JIC
209-08-08	R 2 - 1/2"	3/4" - JIC
209-10-08	R 2 - 1/2"	7/8" - JIC
209-10-10	R 2 - 5/8"	7/8" - JIC
209-12-10	R 2 - 5/8"	1 1/16" - JIC
209-12-12	R 2 - 3/4"	1 1/16" - JIC
209-14-12	R 2 - 3/4"	1 3/16" - JIC
209-16-12	R 2 - 3/4"	1 5/16" - JIC
209-12-16	R 2 - 1"	1 1/16" - JIC
209-16-16	R 2 - 1"	1 5/16" - JIC



## RACORES DESMONTABLES SAE 100 - R-2

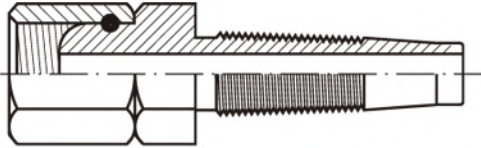

**RACOR TUERCA GIRATORIA METRICO**

CODIGO	Φ TUBO	ROSCA
210-04-04	R 2 - 1/4"	12-150
210-06-04	R 2 - 1/4"	14-150
210-08-04	R 2 - 1/4"	16-150
210-10-04	R 2 - 1/4"	18-150
210-08-06	R 2 - 3/8"	16-150
210-10-06	R 2 - 3/8"	18-150
210-12-06	R 2 - 3/8"	20-150
210-14-06	R 2 - 3/8"	22-150
210-13-08	R 2 - 1/2"	22-150
210-16-08	R 2 - 1/2"	24-150
210-18-08	R 2 - 1/2"	26-150
210-14-10	R 2 - 5/8"	22-150
210-16-10	R 2 - 5/8"	26-150
210-20-10	R 2 - 5/8"	30-200
210-20-12	R 2 - 3/4"	30-150
210-22-12	R 2 - 3/4"	30-200
210-24-12	R 2 - 3/4"	36-150
210-25-12	R 2 - 3/4"	36-200

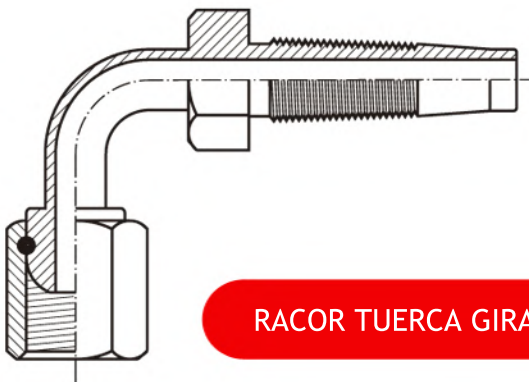

**RACOR TUERCA GIRATORIA GAS CODO 90°**

CODIGO	Φ TUBO	ROSCA
211-04-04	R 2 - 1/4"	1/4" Gas 19
211-06-04	R 2 - 1/4"	3/8" Gas 19
211-06-06	R 2 - 3/8"	3/8" Gas 19
211-08-06	R 2 - 3/8"	1/2" Gas 14
211-08-08	R 2 - 1/2"	1/2" Gas 14
211-12-08	R 2 - 1/2"	3/4" Gas 14
211-10-10	R 2 - 5/8"	5/8" Gas 14
211-12-10	R 2 - 5/8"	3/4" Gas 14
211-12-12	R 2 - 3/4"	3/4" Gas 14
211-16-16	R 2 - 1"	1" Gas 11



## RACORES DESMONTABLES SAE 100 - R-2

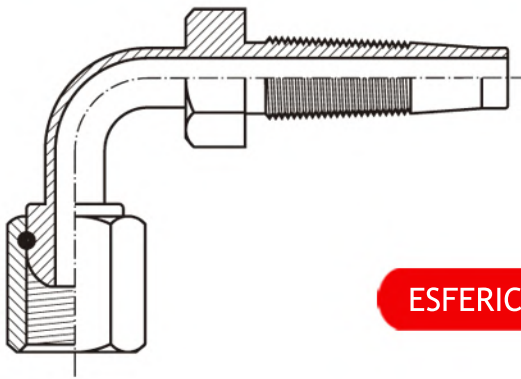

**ESFERICO SOLDAR**

CODIGO	Φ TUBO	ROSCA
219-06-04	R 2 - 1/4"	14/150
219-08-06	R 2 - 3/8"	16/150
219-10-06	R 2 - 3/8"	18/150
219-12-06	R 2 - 3/8"	20/150
219-14-06	R 2 - 3/8"	22/150
219-13-08	R 2 - 1/2"	22/150
219-16-08	R 2 - 1/2"	24/150
219-16-10	R 2 - 5/8"	26/150
219-20-12	R 2 - 3/4"	30/150
219-22-12	R 2 - 3/4"	30/200
219-24-12	R 2 - 3/4"	36/150
219-25-12	R 2 - 3/4"	36/200
219-25-16	R 2 - 1"	38/150
219-30-16	R 2 - 1"	42/200

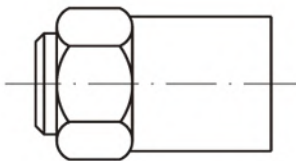

**ESFERICO ROSCADO**

CODIGO	Φ TUBO
218-00-04	R 2 - 1/4"
218-00-06	R 2 - 3/8"
218-00-08	R 2 - 1/2"
218-00-10	R 2 - 5/8"
218-00-12	R 2 - 3/4"
218-00-16	R 2 - 1"
218-00-20	R 2 - 1 1/4"
218-00-24	R 2 - 1 1/2"
218-00-32	R 2 - 2"



## RACORES ADAPTADOR

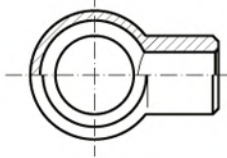

**ESFERICO SOLDAR**

CODIGO	Φ BOLA mm.
225-101	1/4" - 13,5
225-102	3/8" - 16,66
225-103	1/2" - 20,96
225-104	3/4" - 26,44
225-105	1" - 33,25

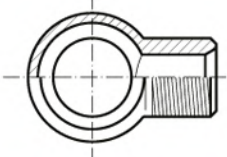

**ESFERICO ROSCADO**

CODIGO	Φ BOLA mm.	ROSCA
225-201	1/4" - 13,5	1/4" GAS
225-202	3/8" - 16,66	3/8" GAS
225-203	1/2" - 20,96	1/2" GAS
225-204	3/4" - 26,44	3/4" GAS
225-205	1" - 33,25	1" GAS

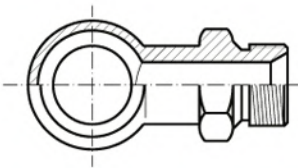

**ESFERICO ROSCADO CON EXAGONAL**

CODIGO	Φ BOLA mm.	ROSCA
225.301	1/4" - 13,5	1/4" GAS
225.302	3/8" - 16,66	3/8" GAS
225.312	3/8" - 16,66	1/2" GAS
225.303	1/2" - 20,96	1/2" GAS
225.304	3/4" - 26,44	3/4" GAS
225.305	1" - 33,25	1" GAS

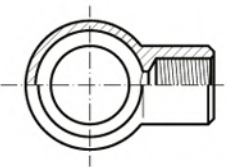

**ESFERICO ROSCADO  
JUNTA TORICA**

CODIGO	Φ BOLA mm.	ROSCA
225-401	1/4" - 13,5	1/4" GAS
225-402	3/8" - 16,66	3/8" GAS
225-403	1/2" - 20,96	1/2" GAS
225-404	3/4" - 26,44	3/4" GAS
225-405	1" - 33,25	1" GAS

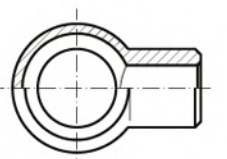

**ESFERICO SOLDAR**

CODIGO	Φ BOLA mm.
225.501	8
225.502	10
225.503	12
225.504	14
225.505	16
225.506	18
225.507	20
225.508	22





## RACORES ADAPTADOR

### 110 MM. LARGO

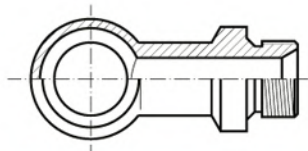

**ESFERICO ROSCADO**

CODIGO	Φ BOLA	ROSCA
225.602	3/8" GAS	3/8" GAS
225.603	3/8" GAS	3/8" GAS
225.604	1/2" GAS	1/2" GAS

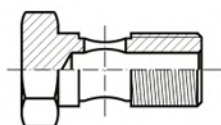

**TORNILLO SIMPLE**

CODIGO	ROSCA
227.100	1/8" GAS
227.101	1/4" GAS
227.102	3/8" GAS
227.103	1/2" GAS
227.104	3/4" GAS
227.105	1" GAS

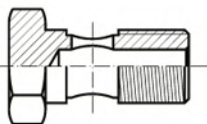

**TORNILLO SIMPLE METRICO**

CODIGO	ROSCA
227.600	n6-100
227.601	n8-100
227.602	10-100 Largo 18 mr
227.609	10-100 Largo 27 mr
227.603	12-150
227.604	14-150
227.605	16-150
227.606	18-150
227.607	20-150
227.608	22-150

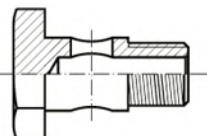

**TORNILLO SIMPLE  
JUNTA TORICA**

CODIGO	ROSCA
227.501	1/4" GAS
227.502	3/8" GAS
227.503	1/2" GAS
227.504	3/4" GAS
227.505	1" GAS

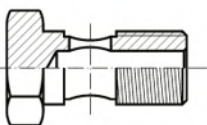

**TORNILLO SIMPLE SAE**

CODIGO	Φ BOLA	ROSCA
227.801	14 mm.	1/2" SAE
227.802	3/8" - 16,66 mm	9/16" SAE



## RACORES ADAPTADOR

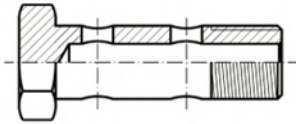

**TORNILLO DOBLE**

CODIGO	ROSCA
227.200	1/8" GAS
227.201	1/4" GAS
227.202	3/8" GAS
227.203	1/2" GAS
227.204	3/4" GAS
227.205	1" GAS

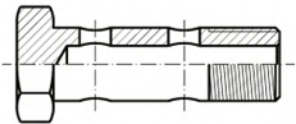

**TORNILLO DOBLE METRICO**

CODIGO	ROSCA
227.697	8-100
227.699	10-100
227.700	12-150
227.701	14-150
227.702	16-150
227.703	18-150
227.704	20-150
227.705	22-150

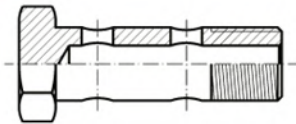

**TORNILLO DOBLE SAE**

CODIGO	Φ BOLA	ROSCA
227.901	3/8"	9/16" SAE

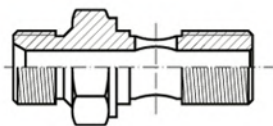

**TORNILLO SIMPLE  
CON PROLONGACION**

CODIGO	ROSCA	ROSCA
227.301	1/4" GAS	1/4" GAS
227.302	3/8" GAS	3/8" GAS
227.303	1/2" GAS	1/2" GAS
227.304	3/4" GAS	3/4" GAS
227.305	1" GAS	1" GAS

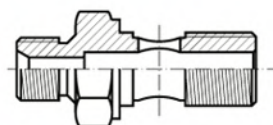

**TORNILLO SIMPLE  
CON PROLONGACION REDUCIDA**

CODIGO	ROSCA	ROSCA
227.402	3/8" GAS	1/4" GAS
227.403	1/2" GAS	3/8" GAS
227.404	3/4" GAS	1/2" GAS
227.405	1" GAS	3/4" GAS



## RACORES ADAPTADOR

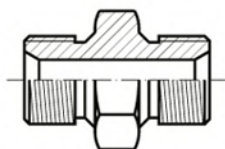

**TORNILLO UNION**

CODIGO	ROSCA	ROSCA
231-100	1/8" GAS	1/8" GAS
231-101	1/4" GAS	1/4" GAS
231-102	3/8" GAS	3/8" GAS
231-103	1/2" GAS	1/2" GAS
231-109	5/8" GAS	5/8" GAS
231-104	3/4" GAS	3/4" GAS
231-105	1" GAS	1" GAS
231-106	1 1/4" GAS	1 1/4" GAS
231-107	1 1/2" GAS	1 1/2" GAS
231-108	2" GAS	2" GAS
232-301	M.16/150	M.16/150

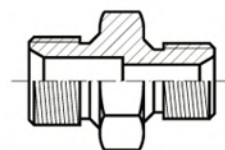

**TORNILLO UNION REDUCTOR**

CODIGO	ROSCA	ROSCA
232-200	1/8" GAS	1/4" GAS
232-201	1/4" GAS	3/8" GAS
232-202	3/8" GAS	1/2" GAS
232-208	1/2" GAS	5/8" GAS
232-209	5/8" GAS	3/4" GAS
232-203	3/4" GAS	1/2" GAS
232-204	1" GAS	3/4" GAS
232-205	1 1/4" GAS	1" GAS
232-206	1 1/2" GAS	1 1/4" GAS
232-207	2" GAS	1 1/2" GAS

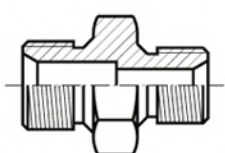

**TORNILLO UNION REDUCTOR**

CODIGO	ROSCA	ROSCA
232-302	3/8" GAS	1/8" GAS
232-303	1/2" GAS	1/4" GAS
232-306	3/4" GAS	1/4" GAS
232-304	3/4" GAS	3/8" GAS
232-305	1" GAS	1/2" GAS
232-307	3/8" GAS	18-150
232-308	1/2" GAS	18-150
232-312	1/2" GAS	22-150
232-309	3/4" GAS	16-150
232-310	3/4" GAS	20-150
232-311	3/4" GAS	22-150

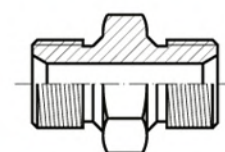

**TORNILLO UNION GAS - SAE**

CODIGO	ROSCA	ROSCA
232-502	3/8" GAS	3/4" SAE
232-503	3/8" GAS	7/8" SAE
232-501	1/2" GAS	3/4" SAE



## RACORES ADAPTADOR

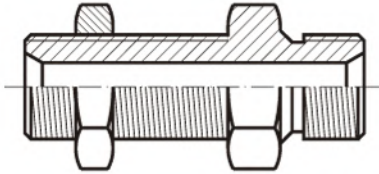

**TORNILLO UNION PASATABIQUES**

CODIGO	ROSCA	ROSCA
<b>TORNILLO</b>		
232-401	1/4" GAS	1/4" GAS
232-402	3/8" GAS	3/8" GAS
232-403	1/2" GAS	1/2" GAS
232-406	5/8" GAS	5/8" GAS
232-404	3/4" GAS	3/4" GAS
232-405	1" GAS	1" GAS
<b>TUERCA</b>		
232-601	1/4" GAS	
232-602	3/8" GAS	
232-603	1/2" GAS	
232-604	3/4" GAS	
232-605	1" GAS	

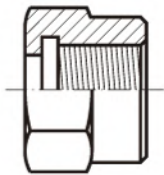

**TUERCA UNION GAS**

CODIGO	ROSCA
233-101	1/4" GAS
233-102	3/8" GAS
233-103	1/2" GAS
233-104	3/4" GAS
233-105	1" GAS
233-106	1 1/4" GAS
233-107	1 1/2" GAS
233-108	2" GAS

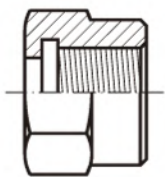

**TUERCA UNION METRICA**

CODIGO	ROSCA
233-201	22-150
233-202	26-150
233-203	30-150

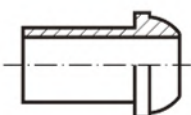

**CONO UNION**

CODIGO	PARA RACOR
234-101	1/4" GAS
234-102	3/8" GAS
234-103	1/2" GAS
234-104	3/4" GAS
234-105	1" GAS
234-106	1 1/4" GAS
234-107	1 1/2" GAS
234-108	2" GAS





## RACORES ADAPTADOR

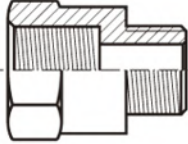

**SUPLEMENTO**

CODIGO	TUERCA	MACHO
235-101	1/4" GAS	1/4" GAS
235-102	3/8" GAS	3/8" GAS
235-103	1/2" GAS	1/2" GAS
235-104	3/4" GAS	3/4" GAS
235-105	1" GAS	1" GAS
235-106	1 1/4" GAS	1 1/4" GAS
235-107	1 1/2" GAS	1 1/2" GAS

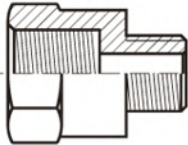

**SUPLEMENTO AUMENTADOR**

CODIGO	TUERCA	MACHO
235-200	1/4" GAS	1/8" GAS
235-201	1/2" GAS	1/4" GAS
235-202	3/8" GAS	1/4" GAS
235-203	1/2" GAS	3/8" GAS
235-204	3/4" GAS	1/2" GAS
235-205	1" GAS	3/4" GAS
235-206	1 1/4" GAS	1" GAS

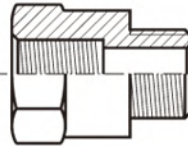

**SUPLEMENTO REDUCTOR**

CODIGO	TUERCA	MACHO
235-300	1/4" GAS	1/8" GAS
235-301	1/4" GAS	3/8" GAS
235-302	3/8" GAS	1/2" GAS
235-303	1/2" GAS	3/4" GAS
235-304	3/4" GAS	1" GAS
235-305	1" GAS	1 1/4" GAS

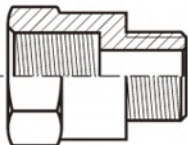

**SUPLEMENTO**

CODIGO	TUERCA	MACHO
235-310	22-150	1/2" GAS
235-311	1/2" GAS	22-150
235-320	3/8" GAS	9/16" SAE
235-401	1/2" GAS	18-150
235-402	18-150	1/2" GAS
235-405	1/2" GAS	3/4" SAE
235-406	3/4" SAE	1/2" GAS
235-407	18/150	3/8" GAS
235-657	22/150	22/150

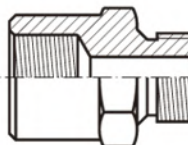

**SUPLEMENTO**

CODIGO	TUERCA	MACHO
235-502	3/4" SAE	1/2" GAS



## RACORES ADAPTADOR

### SUPLEMENTO

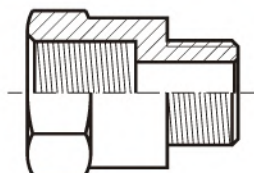

CODIGO	TUERCA	MACHO
235-430	6-100	1/8" GAS
235-100	6-100	1/4" GAS
235-432	8-100	1/8" GAS
235-420	8-100	1/4" GAS
235-658	8-100	8-100
235-434	8-125	1/8" GAS
235-422	8-125	1/4" GAS
235-435	10-100	1/8" GAS
235-308	10-100	1/4" GAS
235-436	10-150	1/8" GAS
235-424	10-150	1/4" GAS
400-201	14-200	1/4" GAS
235-600	3/8" SAE	10-100
235-309	3/8" SAE	1/4" GAS
235-300	1/8" GAS	1/4" GAS
400-200	1/8" GAS	10-100
235-582	1/8" GAS	12-150
235-584	1/8" GAS	14-150
235-586	1/8" GAS	10-150
235-307	1/4" GAS	10-100
235-587	1/4" GAS	16-150

### TAPON CENTRO GIRATORIO

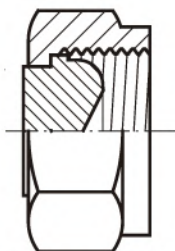

CODIGO	TUERCA
242-101	1/4" GAS
242-102	3/8" GAS
242-103	1/2" GAS
242-107	5/8" GAS
242-104	3/4" GAS
242-105	1" GAS
242-106	1 1/4" GAS



## RACORES ADAPTADOR

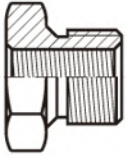

**REDUCTOR INTERIOR**

CODIGO	TUERCA	MACHO
237-101	1/8" GAS	1/4" GAS
237-102	1/8" GAS	3/8" GAS
237-103	1/4" GAS	3/8" GAS
237-104	1/8" GAS	1/2" GAS
237-105	1/4" GAS	1/2" GAS
237-106	3/8" GAS	1/2" GAS
237-118	1/4" GAS	3/4" GAS
237-119	3/8" GAS	3/4" GAS
237-107	1/2" GAS	3/4" GAS
237-120	1/4" GAS	1" GAS
237-121	3/8" GAS	1" GAS
237-122	1/2" GAS	1" GAS
237-108	3/4" GAS	1" GAS
237-123	3/8" GAS	1 1/4" GAS
237-124	1/2" GAS	1 1/4" GAS
237-125	3/4" GAS	1 1/4" GAS
237-109	1" GAS	1 1/4" GAS
237-110	1 1/4" GAS	1 1/2" GAS
257-099	1/4" GAS	M.22/150
257-102	14/150	M.22/150
257-098	16/150	M.22/150
257-097	18/150	M.22/150

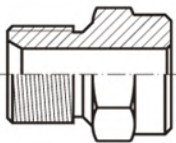

**EMPALME SOLDABLE  
EXAGONAL PEQUEÑO**

CODIGO	MACHO
238-401	1/4" GAS
238-402	3/8" GAS
238-403	1/2" GAS
238-404	3/4" GAS
238-405	1" GAS
238-406	1 1/4" GAS

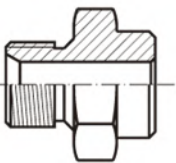

**EMPALME SOLDABLE  
EXAGONAL GRANDE**

CODIGO	MACHO
238-501	1/4" GAS
238-502	3/8" GAS
238-503	1/2" GAS
238-504	3/4" GAS
238-505	1" GAS

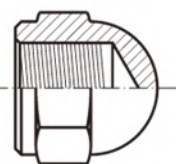

**TAPON TUERCA**

CODIGO	TUERCA
242-300	1/8" GAS
242-301	1/4" GAS
242-302	3/8" GAS
242-303	1/2" GAS
242-304	3/4" GAS
242-305	1" GAS





## RACORES ADAPTADOR

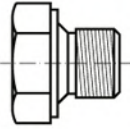

**TAPON MACHO GAS**

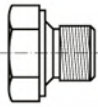

**TAPON MACHO SAE**

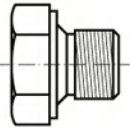

**TAPON MACHO METRICO**



**MANGUITO CILINDRICO HEMBRA**

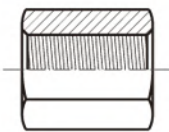

**MANGUITO EXAGONAL HEMBRA**

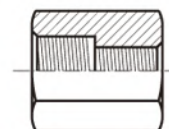

**MANGUITO EXAGONAL REDUCTOR HEMBRAS**

**CODIGO**

243-200  
243-201  
243-202  
243-203  
243-209  
243-204  
243-205  
243-206  
243-207  
243-208

**MACHO**

1/8" GAS  
1/4" GAS  
3/8" GAS  
1/2" GAS  
5/8" GAS  
3/4" GAS  
1" GAS  
1 1/4" GAS  
1 1/2" GAS  
2" GAS

**CODIGO**

243-402  
243-403  
243-404  
243-405

**MACHO**

1/2" SAE  
9/16" SAE  
3/4" SAE  
7/8" SAE

**CODIGO**

243-299  
243-300  
243-301  
243-302  
243-303  
243-304  
243-305

**MACHO**

12-150  
14-150  
16-150  
18-150  
20-150  
22-150  
24-150

**CODIGO**

244-101  
244-102  
244-103  
244-104  
244-105  
244-117  
244-119  
244-122  
244-124

**HEMBRA**

1/4" GAS  
3/8" GAS  
1/2" GAS  
3/4" GAS  
1" GAS  
12/150  
14/150  
16/150  
18/150

**CODIGO**

244-209  
244-200  
244-201  
244-202  
244-203  
244-204  
244-205  
244-206  
244-402  
244-404  
244-210  
244-211

**HEMBRA**

10-100  
1/8" GAS  
1/4" GAS  
3/8" GAS  
1/2" GAS  
3/4" GAS  
1" GAS  
1 1/4" GAS  
22-150  
3/4" SAE  
14-150  
16-150

**CODIGO**

244-307  
244-301  
244-302  
244-308  
244-303  
244-309  
244-304  
244-305  
244-310

**HEMBRA**

3/8" GAS  
1/4" GAS  
3/8" GAS  
1/2" GAS  
1/2" GAS  
1/2" GAS  
3/4" GAS  
1" GAS  
1/2" GAS

**HEMBRA**

1/8" GAS  
1/8" GAS  
1/4" GAS  
1/4" GAS  
3/8" GAS  
18-150  
1/2" GAS  
3/4" GAS  
3/4" GAS





## RACORES ADAPTADOR

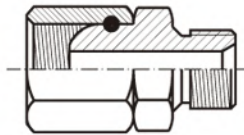

**ADAPTADOR MACHO  
TUERCA GIRATORIA**

CODIGO	HEMBRA	MACHO
247-101	1/4" GAS	1/4" GAS
247-110	3/8" GAS	1/4" GAS
247-102	3/8" GAS	3/8" GAS
247-113	3/8" GAS	1/2" GAS
247-115	1/2" GAS	3/8" GAS
247-103	1/2" GAS	1/2" GAS
247-111	1/2" GAS	8/5" GAS
247-125	1/2" GAS	3/4" GAS
247-117	3/4" GAS	1/2" GAS
247-118	1" GAS	3/4" GAS
247-104	3/4" GAS	3/4" GAS
247-127	3/4" GAS	1" GAS
247-105	1" GAS	1" GAS
247-106	1 1/4" GAS	1 1/4" GAS
247-107	1/2" GAS	7/8" SAE
247-108	1/2" GAS	22-150
247-109	22-150	1/2" GAS
247-120	1 1/2" GAS	1 1/2" GAS

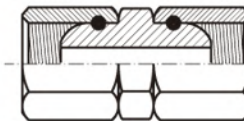

**ADAPTADOR TUERCA GIRATORIA  
TUERCA GIRATORIA**

CODIGO	HEMBRA	HEMBRA
247-201	1/4" GAS	1/4" GAS
247-202	3/8" GAS	3/8" GAS
247-303	3/8" GAS	1/2" GAS
247-203	1/2" GAS	1/2" GAS
247-204	3/4" GAS	3/4" GAS
247-205	1" GAS	1" GAS

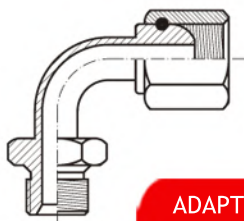

**ADAPTADOR CODO 90°  
MACHO - TUERCA GIRATORIA**

CODIGO	HEMBRA	MACHO
246-101	1/4" GAS	1/4" GAS
246-102	3/8" GAS	3/8" GAS
246-108	3/8" GAS	1/2" GAS
246-103	1/2" GAS	1/2" GAS
246-107	5/8" GAS	5/8" GAS
246-104	3/4" GAS	3/4" GAS
246-105	1" GAS	1" GAS
246-109	1 1/4" GAS	1 1/4" GAS
246-110	1 1/2" GAS	1 1/2" GAS

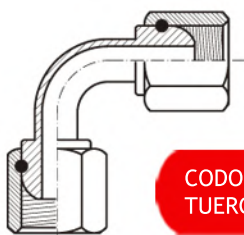

**CODO 90° TUERCA GIRATORIA  
TUERCA GIRATORIA**

CODIGO	HEMBRA	HEMBRA
246-201	1/4" GAS	1/4" GAS
246-202	3/8" GAS	3/8" GAS
246-203	1/2" GAS	1/2" GAS
246-204	3/4" GAS	3/4" GAS
246-205	1" GAS	1" GAS
246-210	7/8" JIC	7/8" JIC



## RACORES ADAPTADOR

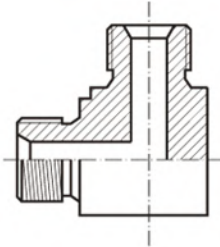

### CODO 90° MACHO CUADRADO MECANIZADO

CODIGO	MACHO	MACHO
239-101	1/4" GAS	1/4" GAS
239-102	3/8" GAS	3/8" GAS
239-103	1/2" GAS	1/2" GAS
239-104	3/4" GAS	3/4" GAS
239-105	1" GAS	1" GAS

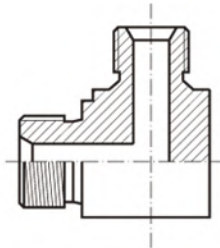

### CODO REDUCTOR 90° MACHOS CUADRADO MECANIZADO

CODIGO	MACHO	MACHO
240-101	1/4" GAS	3/8" GAS
240-102	3/8" GAS	1/2" GAS
240-103	1/2" GAS	3/4" GAS
240-104	3/4" GAS	1" GAS

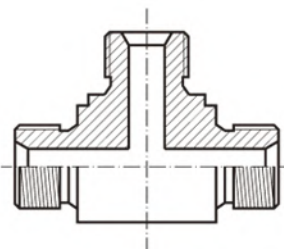

### TE MACHOS CUADRADO MECANIZADO

CODIGO	TRES MACHOS
241-101	1/4" GAS
241-102	3/8" GAS
241-103	1/2" GAS
241-104	3/4" GAS
241-105	1" GAS

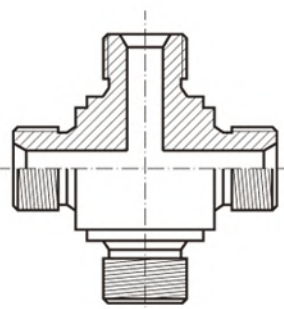

### CRUZ MACHOS CUADRADO MECANIZADO

CODIGO	CUATRO MACHOS
245-101	1/4" GAS
245-102	3/8" GAS
245-103	1/2" GAS
245-104	3/4" GAS
245-105	1" GAS



## ARANDELAS

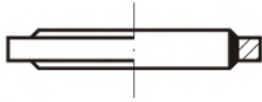

ARANDELAS ACERO  
GOMA RACORES GAS

CODIGO	Φ INTERIOR
347-100	1/8"
347-101	1/4"
347-102	3/8"
347-103	1/2"
347-104	3/4"
347-105	1"
347-106	1 1/4"
347-107	1 1/2"
347-108	2"

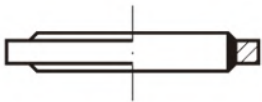

ARANDELAS ACERO  
GOMA RACORES METRICOS

CODIGO	Φ INTERIOR
347-109	10 mm
347-110	12 mm
347-111	14 mm
347-112	18 mm
347-113	20 mm
347-114	22 mm
347-115	26 mm

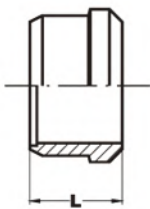

ANILLO DE CIERRE

CODIGO	Φ TUBO MM.	L - ALTO MM.
--------	------------	--------------

### TUBO METRICO

430-101	4	7,2
430-102	6	9,6
430-103	8	10
430-104	10	10
430-105	12	10
430-106	14	10
430-107	15	10
430-108	16	10
430-109	18	10
430-110	20	10
430-111	22	10,5
430-112	25	10,5
430-113	28	10,5
430-114	30	10,5
430-115	32	10,5
430-116	35	10,5
430-117	38	10,5
430-142	42	14

### TUBO GAS

430-118	1/4" - 13,25	10
430-119	3/8" - 16,75	10
430-120	1/2" - 21,25	10
430-121	3/4" - 26,75	10,5
430-122	1" - 33,50	10,5



## RACORES BAJA PRESION

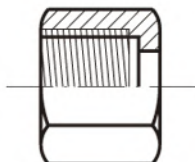

**TUERCA ESPIGA**

CODIGO	ROSCA	Φ TUBO MM.
272-118	1/4" GAS	8
272-119	3/8" GAS	12
272-120	1/2" GAS	15
272-121	3/4" GAS	19
272-122	1" GAS	25
272-123	1 1/4" GAS	30
272-124	1 1/2" GAS	35
272-125	2" GAS	40
272-126	22-150	15
272-127	26-150	19
272-128	30-150	25

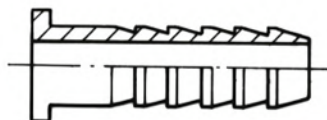

**ASPIGA ASIENTO PLANO**

CODIGO	ROSCA	Φ TUBO MM.
272-129	1/4" GAS	8
272-130	3/8" GAS	12
272-131	1/2" GAS	15
272-132	3/4" GAS	19
272-133	1" GAS	25
272-134	1 1/4" GAS	30
272-135	1 1/2" GAS	35
272-136	2" GAS	40
272-137	22-150	15
272-138	26-150	19
272-139	30-150	25

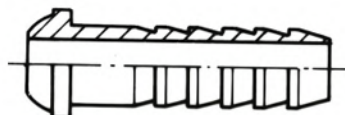

**ESPIGA ASIENTO BOLA**

CODIGO	ROSCA	Φ TUBO MM.
272-140	1/4" GAS	8
272-141	3/8" GAS	12
272-142	1/2" GAS	15
272-143	3/4" GAS	19
272-144	1" GAS	25
272-145	1 1/4" GAS	30
272-146	1 1/2" GAS	35
272-147	2" GAS	40
272-148	22-150	15
272-149	26-150	19
272-150	30-150	25





## RACORES BAJA PRESION

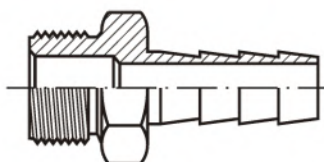

### ESPIGA MACHO BAJA PRESION

CODIGO	ROSCA	Φ TUBO MM.
272-101	1/4" GAS	6
272-102	1/4" GAS	8
272-103	1/4" GAS	10
272-104	3/8" GAS	8
272-105	3/8" GAS	10
272-106	3/8" GAS	12
272-107	3/8" GAS	15
272-108	1/2" GAS	10
272-109	1/2" GAS	12
272-110	1/2" GAS	15
272-111	5/8" GAS	15
272-112	3/4" GAS	15
272-113	3/4" GAS	19
272-114	1" GAS	25
272-115	1 1/4" GAS	30
272-115 A	1 1/4" GAS	32
272-116	1 1/2" GAS	35
272-117	2" GAS	40
272-170	2" GAS	50
272-175	22-150	15



### ESPIGA DOBLE BAJA PRESION

CODIGO	Φ TUBO MM.	Φ TUBO MM.
272-151	6	6
272-152	8	8
272-153	10	10
272-154	12	12
272-155	15	15
272-156	19	19
272-159	25	25



## RACORES GASOIL

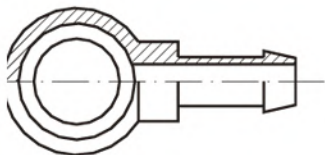

**BOLA CONEXION**

CODIGO	Φ INT. BOLA MM.	PARA TUBO
280-580	14	7 x 14
280-581	14	5 x 11
280-585	12	7 x 14
280-586	12	5 x 11
280-588	8	7 x 14
280-600	14	9 x 16
280-601	14	11 x 17
280-602	12	9 x 16
280-603	10	7 x 14
280-604	10	5 x 11
280-605	8	5 x 11

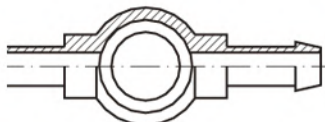

**BOLA CONEXION DOBLE SALIDA**

CODIGO	Φ INT. BOLA MM.	PARA TUBO
280-606	8	5 x 11
280-607	10	5 x 11

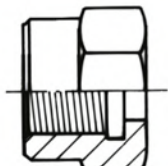

**RACOR TUERCA**

CODIGO	ROSCA	PARA TUBO
282-619	10-100	5 x 11
282-620	1/8" GAS	5 x 11
282-621	12-150	7 x 14
282-622	14-150	9 x 16
282-623	16-150	9 x 16
282-624	1/4" GAS	9 x 16

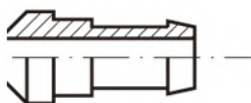

**BOQUILLA**

CODIGO	ROSCA	PARA TUBO MM.
283-630	10-100	5 x 11
283-631	1/8" GAS	5 x 11
283-632	12-150	9 x 16
283-633	14-150	9 x 16
283-634	16-150	9 x 16
283-635	1/4" GAS	9 x 16

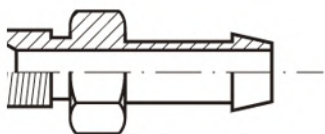

**RACOR MACHO**

CODIGO	ROSCA	PARA TUBO MM.
282-625	10-100	5 x 11
282-626	1/8" GAS	5 x 11
282-627	12-150	9 x 16
282-628	14-150	9 x 16
282-629	16-150	9 x 16



## RACORES GASOIL



RACOR UNION TUBO RILSAN

### CODIGO

299-701  
299-702  
299-703

### Φ TUBO

4 x 6  
6 x 8  
8 x 10

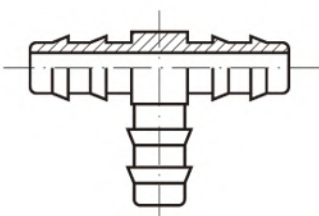

RACOR UNION TUBO RILSAN "TE"

### CODIGO

285-404  
285-406  
285-408

### Φ TUBO

4 x 6  
6 x 8  
8 x 10

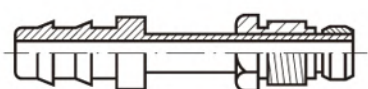

RACOR MACHO GIRATORIO  
RECTO TUBO RILSAN

### CODIGO

298-722  
298-723

### Φ TUBO

6 x 8  
8 x 10

### ROSCA

1/2" SAE  
1/2" SAE

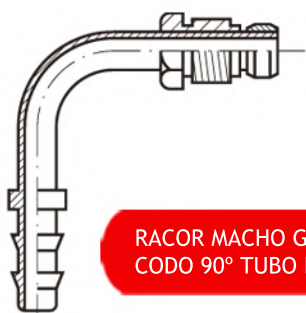

RACOR MACHO GIRATORIO  
CODO 90° TUBO RILSAN

### CODIGO

298-732  
298-733

### Φ TUBO

6 x 8  
8 x 10

### ROSCA

1/2" SAE  
1/2" SAE



## RACORES GASOIL

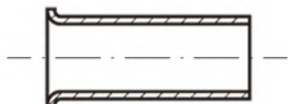

**PROTECTOR INTERIOR  
TUBO RISLAN**

CODIGO	Φ EXT.	PARA TUBO
31270600	4 mm	4 x 6
31270800	6 mm	6 x 8
31271000	8 mm	8 x 10
31271200	10 mm	10 x 12
31271400	12 mm	12 x 14
31271600	14 mm	14 x 16



**OVALILLOS LATON  
PARA TUBO COBRE**

CODIGO	Φ EXT. TUBO
31240600	6 mm
31240800	8 mm
31241000	10 mm
31241200	12 mm



**OVALILLOS LATON  
PARA TUBO COBRE**

CODIGO	PARA TUBO MM.
431-720	4
431-721	5
431-722	6
431-723	8
431-724	10
431-725	12
431-726	14
431-727	16
431-728	18
431-729	20
431-735	1/4"
431-736	3/8"





## RACORES GASOIL

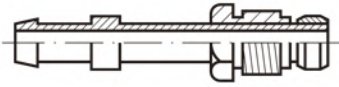

CODIGO	Φ TUBO	ROSCA
298-700	6 mm	1/2" SAE
298-701	8 mm	1/2" SAE

### RACOR MACHO GIRATORIO RECTO TUBO GOMA

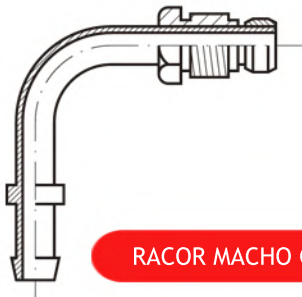

CODIGO	Φ TUBO	ROSCA
298-705	6 mm	1/2" SAE
298-706	8 mm	1/2" SAE

### RACOR MACHO GIRATORIO CODO 90° TUBO GOMA

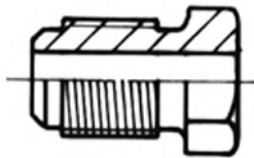

### RACOR MACHO METRICO

CODIGO	ROSCA	PARA TUBO MM.
299-284	8-125	4
299-285	8-125	5
299-305	10-100	5
299-306	10-100	5,5
299-307	10-100	6
299-315	10-125	5,5
299-325	12-100	5
299-326	12-100	6
299-335	12-125	5
299-336	12-125	6
299-338	12-125	8

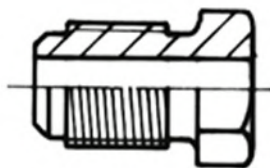

### RACOR MACHO SAE

CODIGO	ROSCA	PARA TUBO MM.
299-145	7/16" SAE	5
299-146	7/16" SAE	6
299-135	3/8" SAE CORTO	5
299-136	3/8" SAE LARGO	5
299-155	1/2" SAE CORTO	6
299-156	1/2" SAE LARGO	6
299-157	1/2" SAE	6,35
299-158	1/2" SAE CORTO	8
299-159	1/2" SAE LARGO	8



## RACORES GASOIL

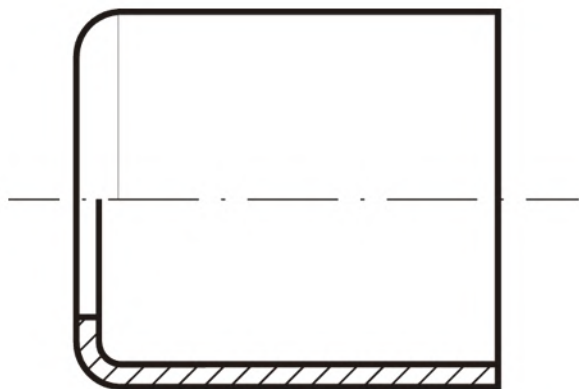

## CAMPANAS HIERRO TUBO GASOIL

<b>CODIGO</b>	<b>Φ INTERIOR MM.</b>	<b>Φ TALADRO MM.</b>	<b>LARGO</b>
447-609	9,5	7	12
447-610	10,5	7	13
447-611	11,5	7	14
447-612	12,5	7,5	15
447-613	13,5	10	16
447-614	14,5	10	17
447-615	15,5	10	17
447-617	17,5	12	21
447-618	18,5	13	22
447-619	19,5	13	22
447-620	20,5	14	23
447-621	21,5	16	24
447-622	22,5	16	27
447-624	24,5	17	28
447-625	25,5	17	30
447-626	26,5	19,5	30
447-630	30,5	22,5	31
447-631	31,5	22	32
447-633	33,5	25	33
447-635	35	25,5	35
447-639	39	26,5	36,5
447-641	41	31	49
447-646	46	37	42
447-647	46	32	48
447-651	51	41	56
447-656	56	41	61
447-661	61	51	64



## HERRAMIENTA PARA PELAR TUBO ALTA PRESION

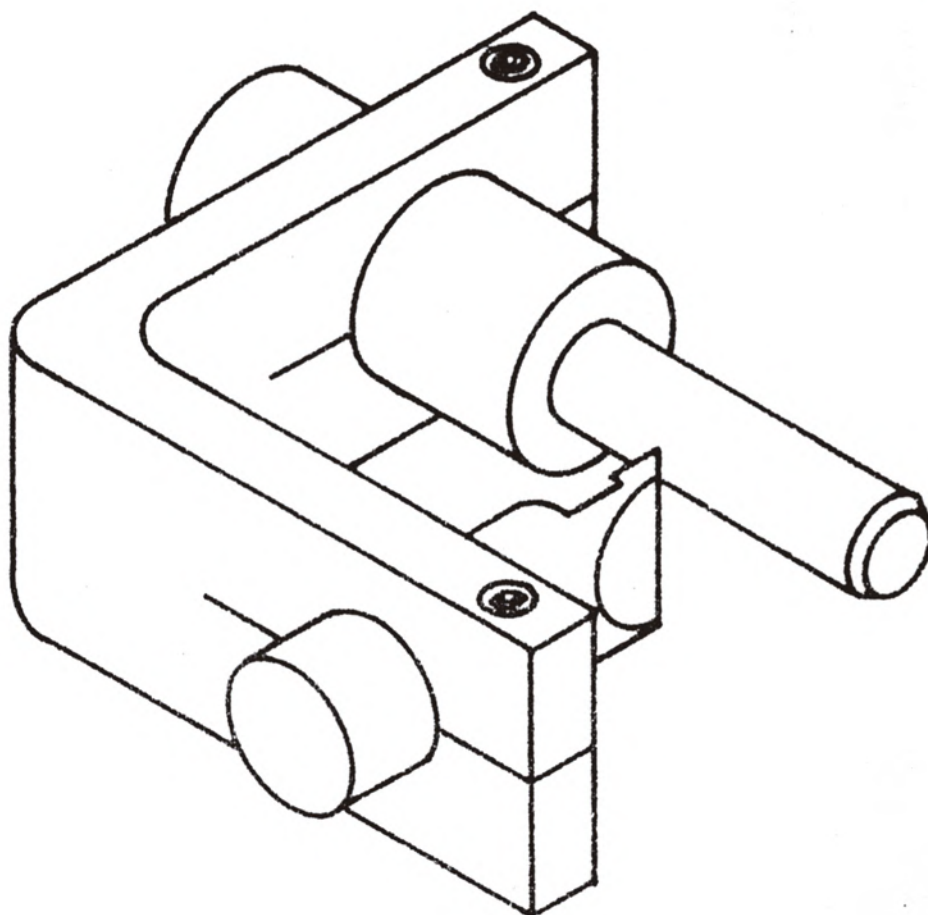

## HERRAMIENTA PELAR TUBO R1 - R2

**CODIGO**

171-101  
171-102  
171-103  
171-104  
171-105

**PARA TUBO**

R2 - 1/4"  
R2 - 3/8"  
R2 - 1/2"  
R2 - 3/4"  
R2 - 1"



## MAQUINA REMACHAR TUBO GASOIL

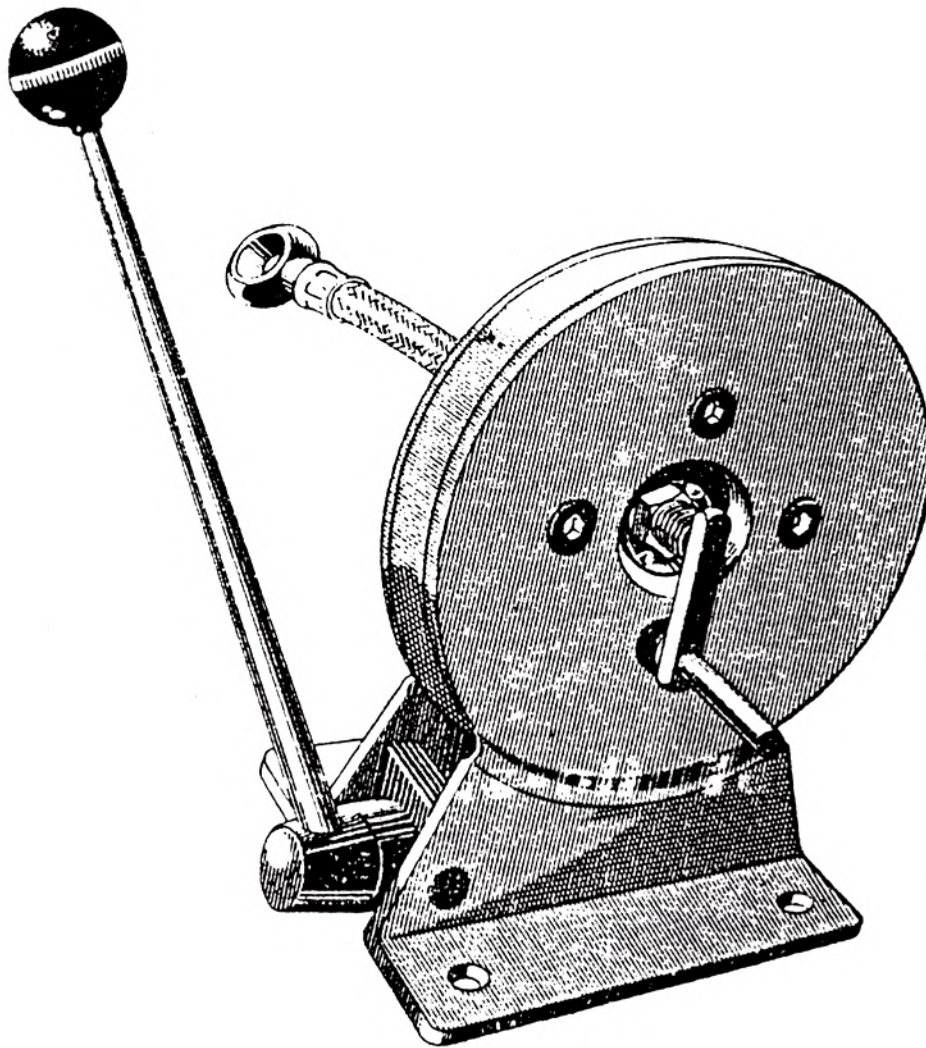

**CODIGO**

445-400

**DESCRIPCION**

TUBO HASTA 24 mm. DE DIAMETRO





## TUBO GASOIL - ABRAZADERAS



**CARACTERISTICAS:**

Conecta y desconecta el circuito hidráulico con facilidad y rapidez.  
Ambas mitades al desconectarse se cierran automáticamente.  
Permiten el paso de aceite sin pérdida de presión.  
Temperatura de trabajo de -40 a 250°C.  
En todos los tamaños presión de trabajo 250 BARS

## VALVULA CONEXION RAPIDA STANDAR

CODIGOS			ROSCA
COMPLETA	MACHO	HEMBRA	
390-101	392-101	393-101	1/4" GAS
390-102	392-102	393-102	3/8" GAS
390-103	392-103	393-103	1/2" GAS
390-104	392-104	393-104	3/4" GAS
390-105	392-105	393-105	1" GAS



## GUARDAPOLVO VALVULA

CODIGO	ARTICULO
391-103	Juego guardapolvo 1/2"
391-104	Tapón guardapolvo 1/2"
391-105	Tapa guardapolvo 1/2"

**CARACTERISTICAS:**

Material altamente resistente al aceite, intemperie, etc.  
Anilla sujeción



## TUBO GASOIL - ABRAZADERAS



### TUBO GASOIL

CODIGO	Φ INTERIOR	Φ EXTERIOR
101-609	9 mm.	16 mm
101-610	7 mm.	13 mm
101-611	5 mm.	11 mm

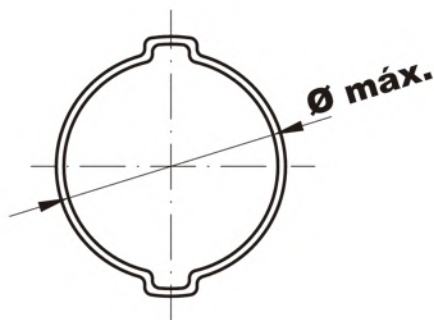
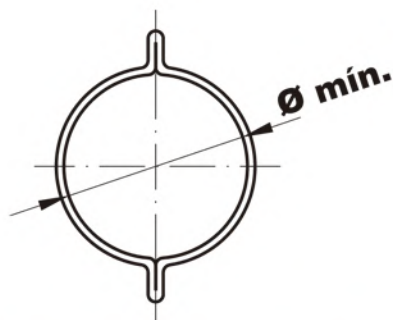

### ABRAZADERA DOS OREJAS

CODIGO	MEDIDAS EN MM. Φ MIN. - Φ MAX.	ANCHURA FLEJE MM.
461-101	9 - 11	7
461-102	11 - 13	7
461-103	13 - 15	8
461-104	15 - 18	8
461-105	17 - 20	8
461-106	20 - 23	9
461-107	23-25	9
461-108	25 - 28	10
461-109	28 - 31	10



**RACORES PRENSADOS SAE 100 - R-1 R-2**

**ESPIGA ITALIANA**

**RACOR MACHO GAS**

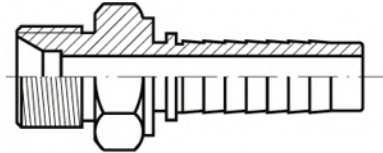

CODIGO	Φ TUBO	ROSCA
103-02-04-P	R 2 - 1/4"	1/8" Gas
103-04-04-P	R 2 - 1/4"	1/4" Gas
103-04-05-P	R 2 - 5/16"	1/4" Gas
103-06-05-P	R 2 - 5/16"	3/8" Gas
103-06-06-P	R 2 - 3/8"	3/8" Gas
103-08-06-P	R 2 - 3/8"	1/2" Gas
103-08-08-P	R 2 - 1/2"	1/2" Gas
103-10-08-P	R 2 - 1/2"	5/8" Gas
103-10-10-P	R 2 - 5/8"	5/8" Gas
103-12-10-P	R 2 - 5/8"	3/4" Gas
103-12-12-P	R 2 - 3/4"	3/4" Gas
103-16-16-P	R 2 - 1"	1" GAS

**RACOR HEMBRA GAS**

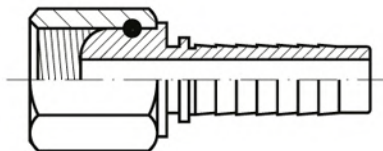

CODIGO	Φ TUBO	ROSCA
108-04-04-P	R 2 - 1/4"	1/4" Gas
108-06-04-P	R 2 - 1/4"	3/8" Gas
108-04-05-P	R 2 - 5/16"	1/4" Gas
108-06-05-P	R 2 - 5/16"	3/8" Gas
108-06-06-P	R 2 - 3/8"	3/8" Gas
108-08-06-P	R 2 - 3/8"	1/2" Gas
108-06-08-P	R 2 - 1/2"	3/8" Gas
108-08-08-P	R 2 - 1/2"	1/2" Gas
108-12-08-P	R 2 - 1/2"	3/4" Gas
108-10-10-P	R 2 - 5/8"	5/8" Gas
108-12-10-P	R 2 - 5/8"	3/4" Gas
108-12-12-P	R 2 - 3/4"	3/4" Gas
108-16-12-P	R 2 - 3/4"	1" Gas
108.1616-P	R 2 - 1"	1" Gas



## RACORES PRENSADOS SAE 100 - R-1 R-2

ESPIGA ITALIANA

### RACOR MACHO METRICO

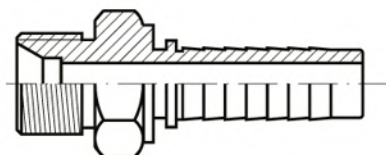

CODIGO	Φ TUBO	ROSCA
105-02-03-P	R 2 - 3/16"	10/100
105-02-04-P	R 2 - 1/4"	10/100
105-04-04-P	R 2 - 1/4"	12/150
105-06-04-P	R 2 - 1/4"	14/150
105-06-05-P	R 2 - 5/16"	14/150
105-10-05-P	R 2 - 5/16"	18/150
105-10-06-P	R 2 - 3/8"	18/150
105-12-06-P	R 2 - 3/8"	20/150
105-14-06-P	R 2 - 3/8"	22/150
105-12-08-P	R 2 - 1/2"	22/150
105-14-10-P	R 2 - 5/8"	26/150
105-20-12-P	R 2 - 3/4"	30/150

### RACOR HEMBRA METRICO

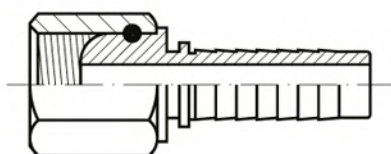

CODIGO	Φ TUBO	ROSCA
110-02-04-P	R 2 - 1/4"	10/100
110-04-04-P	R 2 - 1/4"	12/150
110-06-04-P	R 2 - 1/4"	14/150
110-08-04-P	R 2 - 1/4"	16/150
110-06-05-P	R 2 - 5/16"	14/150
110-08-05-P	R 2 - 5/16"	16/150
110-08-06-P	R 2 - 3/8"	16/150
110-10-06-P	R 2 - 3/8"	18/150
110-12-06-P	R 2 - 3/8"	20/150
110-14-06-P	R 2 - 3/8"	22/150
110-13-08-P	R 2 - 1/2"	22/150
110-16-10-P	R 2 - 5/8"	26/150
110-20-12-P	R 2 - 3/4"	30/150





## RACORES PRENSADOS SAE 100 - R-1 R-2

ESPIGA ITALIANA

### RACOR MACHO JIC

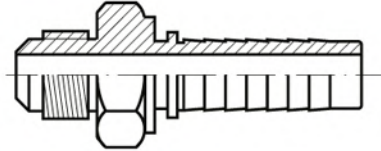

CODIGO	Φ TUBO	ROSCA
106-04-04-P	R 2 - 1/4"	7/16" Jic
106-05-04-P	R 2 - 1/4"	1/2" Jic
106-06-04-P	R 2 - 1/4"	9/16" Jic
106-10-04-P	R 2 - 1/4"	3/4" Jic
106-05-05-P	R 2 - 5/16"	1/2" Jic
106-08-05-P	R 2 - 5/16"	9/16" Jic
106-06-06-P	R 2 - 3/8"	9/16" Jic
106-10-06-P	R 2 - 3/8"	5/8" Jic
106-08-06-P	R 2 - 3/8"	3/4" Jic
106-08-08-P	R 2 - 1/2"	3/4" Jic
106-10-08-P	R 2 - 1/2"	7/8" Jic
106-12-08-P	R 2 - 1/2"	1 1/16" Jic
106-10-10-P	R 2 - 5/8"	7/8" Jic
106-12-10-P	R 2 - 5/8"	1 1/16" Jic
106-12-12-P	R 2 - 3/4"	1 1/16" Jic
106-16-12-P	R 2 - 3/4"	1 5/16" Jic

### RACOR HEMBRA JIC

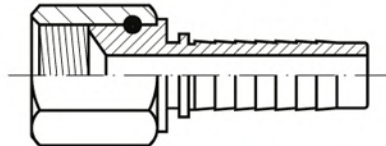

CODIGO	Φ TUBO	ROSCA
109-04-04-P	R 2 - 1/4"	7/16" Jic
109-05-04-P	R 2 - 1/4"	1/2" Jic
109-06-04-P	R 2 - 1/4"	9/16" Jic
109-05-05-P	R 2 - 5/16"	1/2" Jic
109-08-05-P	R 2 - 5/16"	9/16" Jic
109-06-06-P	R 2 - 3/8"	9/16" Jic
109-07-06-P	R 2 - 3/8"	5/8" Jic
109-08-06-P	R 2 - 3/8"	3/4" Jic
109-10-06-P	R 2 - 3/8"	7/8" Jic
109-08-08-P	R 2 - 1/2"	3/4" Jic
109-10-08-P	R 2 - 1/2"	7/8" Jic
109-10-10-P	R 2 - 5/8"	7/8" Jic
109-12-10-P	R 2 - 5/8"	1 1/16" Jic
109-12-12-P	R 2 - 3/4"	1 1/16" Jic
109-16-12-P	R 2 - 3/4"	1 5/16" Jic



## RACORES PRENSADOS SAE 100 - R-1 R-2

ESPIGA ITALIANA

### RACOR HEMBRA CODO 90° GAS

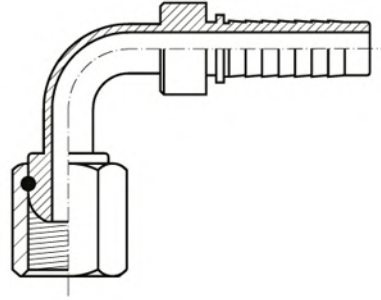

CODIGO	Φ TUBO	ROSCA
111-04-04-P	R 2 - 1/4"	1/4" Gas
111-06-04-P	R 2 - 1/4"	3/8" Gas
111-04-05-P	R 2 - 5/16"	1/4" Gas
111-06-05-P	R 2 - 5/16"	3/8" Gas
111-06-06-P	R 2 - 3/8"	3/8" Gas
111-08-06-P	R 2 - 3/8"	1/2" Gas
111-08-08-P	R 2 - 1/2"	1/2" Gas
111-12-08-P	R 2 - 1/2"	3/4" Gas
111-10-10-P	R 2 - 5/8"	5/8" Gas
111-12-10-P	R 2 - 5/8"	3/4" Gas
111-10-12-P	R 2 - 3/4"	1/2" Gas
111-12-12-P	R 2 - 3/4"	3/4" Gas

### RACOR HEMBRA CODO 90° JIC

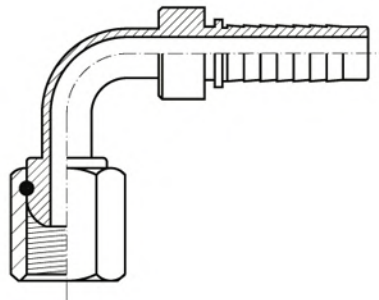

CODIGO	Φ TUBO	ROSCA
121-03-04-P	R 2 - 1/4"	7/16" Jic
121-04-04-P	R 2 - 1/4"	9/16" Jic
121-05-04-P	R 2 - 1/4"	1/2" Jic
121-06-06-P	R 2 - 3/8"	9/16" Jic
121-08-06-P	R 2 - 3/8"	3/4" Jic
121-08-08-P	R 2 - 1/2"	3/4" Jic
121-10-08-P	R 2 - 1/2"	7/8" Jic
121-12-10-P	R 2 - 5/8"	7/8" Jic
121-10-10-P	R 2 - 5/8"	1 1/16" Jic
121-12-12-P	R 2 - 3/4"	1 1/16" Jic



**RACORES PRENSADOS SAE 100 - R-1 R-2**

**ESPIGA ITALIANA**

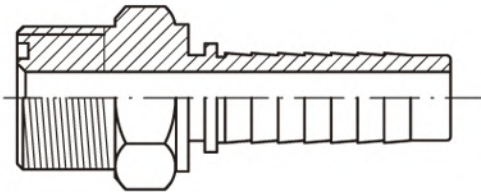

**RACOR MACHO ORS**

<b>CODIGO</b>	<b>Φ TUBO</b>	<b>ROSCA</b>
104-04-04-P	R 2 - 1/4"	9/16" - 18
104-06-06-P	R 2 - 3/8"	11/16" - 16
104-08-08-P	R 2 - 1/2"	13/16" - 16
104-10-10-P	R 2 - 5/8"	1" - 14
104-12-12-P	R 2 - 3/4"	1 3/16" - 12
104-16-16-P	R 2 - 1"	1 7/16" - 12

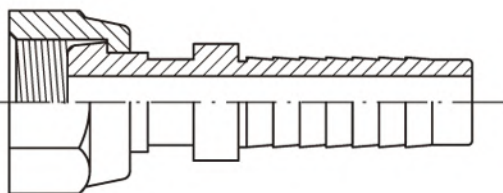

**RACOR HEMBRA ORS**

<b>CODIGO</b>	<b>Φ TUBO</b>	<b>ROSCA</b>
125-04-04-P	R 2 - 1/4"	9/16" - 18
125-06-06-P	R 2 - 3/8"	11/16" - 16
125-10-10-P	R 2 - 5/8"	1" - 14
125-12-12-P	R 2 - 3/4"	1 3/16" - 12
125-16-12-P	R 2 - 3/4"	1 7/16" - 12
125-16-16-P	R 2 - 1"	1 7/16" - 12



## RACORES PRENSADOS SAE 100 - R-1 R-2

ESPIGA ITALIANA

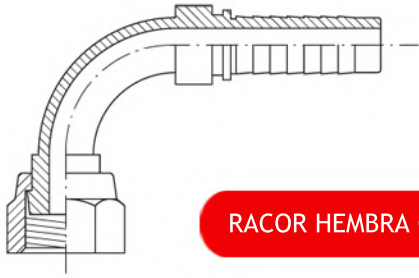

RACOR HEMBRA CODO 90° ORS

CODIGO	Φ TUBO	ROSCA
126-04-04-P	R 2 - 1/4"	9/16" - 18
126-06-06-P	R 2 - 3/8"	11/16" - 16
126-08-08-P	R 2 - 1/2"	13/16" - 16
126-10-10-P	R 2 - 5/8"	1" - 14
126-12-12-P	R 2 - 3/4"	1 3/16" - 12
126-16-16-P	R 2 - 1"	1 7/16" - 12

## CASQUILLOS PARA PRENSAR

### SAE 100 - R-1

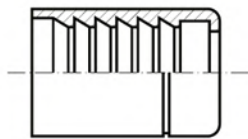

CODIGO	PARA TUBO
118-00-04-P	R-1 y R-5 1/4"
118-00-05-P	R-1 y R-5 5/16"
118-00-06-P	R-1 y R-5 3/8"
118-00-08-P	R-1 y R-5 1/2"
118-00-10-P	R-1 y R-5 5/8"
118-00-12-P	R-1 y R-5 3/4"
118-00-16-P	R-1 y R-5 1"
118-00-20-P	R-1 y R-5 1 1/4"
118-00-24-P	R-1 y R-5 1 1/2"
118-00-32-P	R-1 y R-5 2"

### SAE 100 - R-2

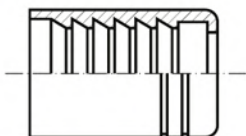

CODIGO	PARA TUBO
220-00-04-P	R-2 1/4"
220-00-05-P	R-2 5/16"
220-00-06-P	R-2 3/8"
220-00-08-P	R-2 1/2"
220-00-10-P	R-2 5/8"
220-00-12-P	R-2 3/4"
220-00-16-P	R-2 1"

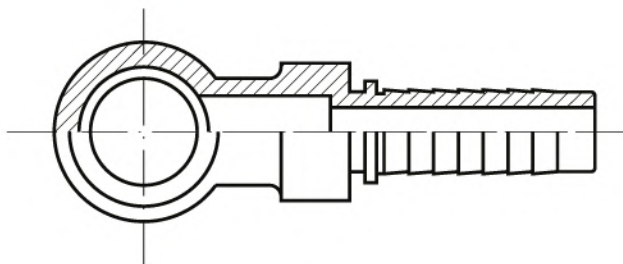

**RACORES PRENSADOS SAE 100 - R-1 R-2**

**RACOR ORIENTABLE GAS**

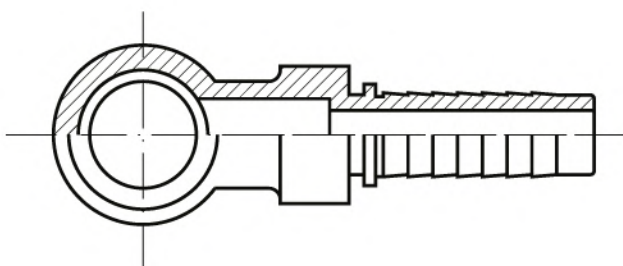
<b>CODIGO</b>	<b>Φ TUBO</b>	<b>TORNILLO</b>	<b>PRECIO (sin casquillo)</b>
107-04-04-P	R 2 - 1/4"	1/4" Gas	
107-06-04-P	R 2 - 1/4"	3/8" Gas	
107-04-05-P	R 2 - 5/16"	1/4" Gas	
107-06-05-P	R 2 - 5/16"	3/8" Gas	
107-06-06-P	R 2 - 3/8"	3/8" Gas	
107-08-06-P	R 2 - 3/8"	1/2" Gas	
107-06-08-P	R 2 - 1/2"	3/8" Gas	
107-08-08-P	R 2 - 1/2"	1/2" Gas	
107-08-10-P	R 2 - 5/8"	1/2" Gas	
107-12-12-P	R 2 - 3/4"	3/4" Gas	



**RACOR ORIENTABLE METRICO**

<b>CODIGO</b>	<b>Φ TUBO</b>	<b>TORNILLO</b>	<b>PRECIO (sin casquillo)</b>
107-20.05-P	R 2 - 5/16"	14 mm	

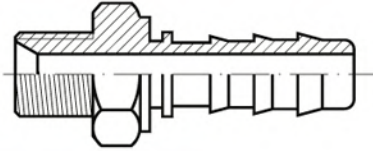

**RACORES PRENSADOS SAE 100 - R-1 R-2**

**RACOR MACHO GAS**



CODIGO	Φ TUBO	ROSCA
103-04-04-X	R 2 - 1/4"	1/4" Gas
103-06-04-X	R 2 - 1/4"	3/8" Gas
103-06-06-X	R 2 - 3/8"	3/8" Gas
103-08-06-X	R 2 - 3/8"	1/2" Gas
103-08-08-X	R 2 - 1/2"	1/2" Gas
103-12-12-X	R 2 - 3/4"	3/4" Gas
103-16-16-X	R 2 - 1"	1" Gas

**RACOR MACHO JIC**

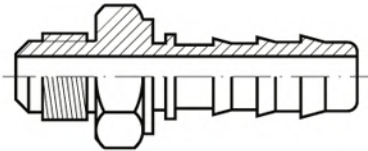

CODIGO	Φ TUBO	ROSCA
106-08-06-X	R 2 - 3/8"	3/4" Jic
106-10-08-X	R 2 - 1/2"	7/8" Jic

**RACOR MACHO METRICO**

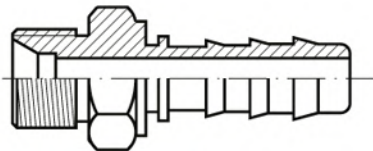

CODIGO	Φ TUBO	ROSCA
105-08-06-X	R 2 - 3/8"	16/150
105-12-08-X	R 2 - 1/2"	22/150
105-16-08-X	R 2 - 1/2"	24/150

**RACOR ORIENTABLE GAS**

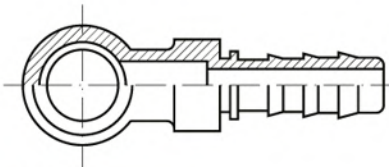

CODIGO	Φ TUBO	TORNILLO
107-04-04-X	R 2 - 1/4"	1/4" GAS
107-06-06-X	R 2 - 3/8"	3/8" GAS
107-08-08-X	R 2 - 1/2"	1/2" GAS



**RACOR HEMBRA GAS**

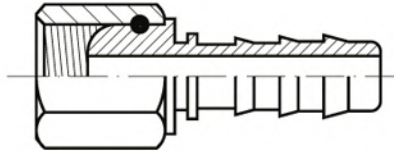

CODIGO	Φ TUBO	ROSCA
108-04-04-X	R 2 - 1/4"	1/4" Gas
108-06-04-X	R 2 - 1/4"	3/8" Gas
108-06-06-X	R 2 - 3/8"	3/8" Gas
108-08-06-X	R 2 - 3/8"	1/2" Gas
108-08-08-X	R 2 - 1/2"	1/2" Gas
108-12-12-X	R 2 - 3/4"	3/4" Gas
108-16-16-X	R 2 - 1"	1" Gas

**RACOR HEMBRA JIC**

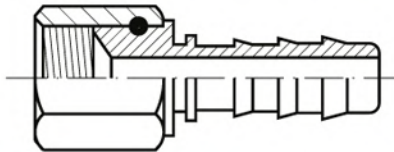

CODIGO	Φ TUBO	ROSCA
109-06-04-X	R 2 - 1/4"	9/16" Jic
109-06-06-X	R 2 - 3/8"	9/16" Jic
109-07-06-X	R 2 - 3/8"	5/8" Jic
109-08-06-X	R 2 - 3/8"	3/4" Jic
109-10-08-X	R 2 - 1/2"	7/8" Jic

**RACOR HEMBRA METRICA**

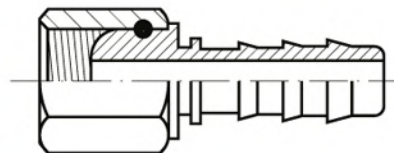

CODIGO	Φ TUBO	ROSCA
110-08-06-X	R 2 - 3/8"	16/150
110-10-06-X	R 2 - 3/8"	18/150
110-12-06-X	R 2 - 3/8"	20/150
110-13-08-X	R 2 - 1/2"	22/150
110-16-08-X	R 2 - 1/2"	24/150



**INOXIDABLE**

**RACORES PRENSADOS SAE 100 - R-1 R-2**

**ESPIGA AMERICANA**

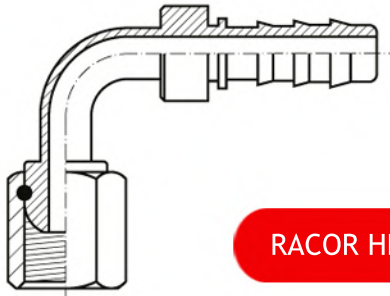

**RACOR HEMBRA CODO 90° GAS**

CODIGO	Φ TUBO	ROSCA
111-04-04-X	R 2 - 1/4"	1/4" Gas
111-06-06-X	R 2 - 3/8"	3/8" Gas
111-08-08-X	R 2 - 1/2"	1/2" Gas
111-12-12-X	R 2 - 3/4"	3/4" Gas

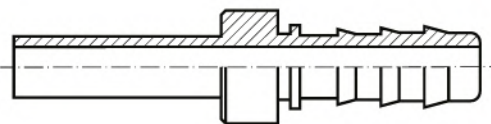

**RACOR TUBULAR METRO**

CODIGO	Φ TUBO	Φ TUBO
122-02-04-X	R 2 - 1/4"	6 mm

**SAE 100 - R-2**

**CASQUILLOS PARA PRENSAR "INOXIDABLE"**

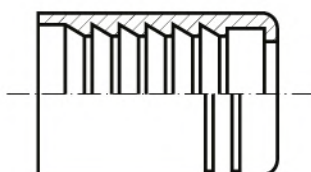

CODIGO	PARA TUBO
220-00-04-X	R-2 1/4"
220-00-06-X	R-2 3/8"
220-00-08-X	R-2 1/2"
220-00-12-X	R-2 3/4"
220-00-16-X	R-2 1"





**RACORES ADAPTADOR**

**INOXIDABLE**

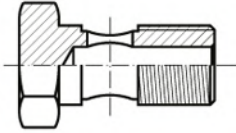

**TORNILLO SIMPLE**

CODIGO	ROSCA
227.101-X	1/4" GAS
227.102-X	3/8" GAS
227.103-X	1/2" GAS

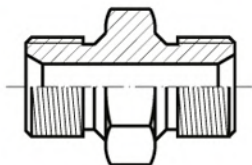

**TORNILLO UNION**

CODIGO	ROSCA	ROSCA
231-101-X	1/4" GAS	1/4" GAS
231-102-X	3/8" GAS	3/8" GAS
231-103-X	1/2" GAS	1/2" GAS
231-104-X	3/4" GAS	3/4" GAS
231-105-X	1" GAS	1" GAS
231-106-X	1 1/4" GAS	1 1/4" GAS
231-107-X	1 1/2" GAS	1 1/2" GAS

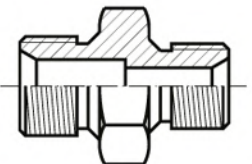

**TORNILLO UNION REDUCTOR**

CODIGO	ROSCA	ROSCA
232-201-X	1/4" GAS	3/8" GAS
232-202-X	3/8" GAS	1/2" GAS
232-203-X	1/2" GAS	3/4" GAS
232-204-X	3/4" GAS	1" GAS
232-205-X	1" GAS	1 1/4" GAS
232-206-X	1 1/4" GAS	1 1/2" GAS
232-207-X	1 1/2" GAS	2" GAS

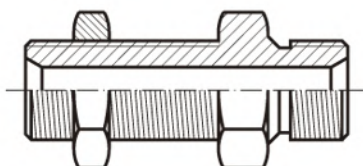

**TORNILLO UNION PASATABIQUES**

CODIGO	ROSCA	ROSCA
<b>TORNILLO</b>		
232.401-X	1/4" GAS	1/4" GAS
232.402-X	3/8" GAS	3/8" GAS
232.403-X	1/2" GAS	1/2" GAS
<b>TUERCA</b>		
232.601-X	1/4" GAS	
232.602-X	3/8" GAS	
232.603-X	1/2" GAS	